



JDV  
CONTROL  
VALVES



# SBS Series

## Thread Ball valve



# Contents

REDUCE PORT ONE PIECE SCREWED BALL VALVE.....	01-16
FULL-BORE ONE-PIECE FLANGED BALL VALVE.....	17-18
FULL-BORE TWO-PIECE SCREWED BALL VALVE.....	19-26
REDUCE PORT TWO-PIECE SCREWED BALL VALVE.....	27-30
FULL-BORE TWO-PIECE FLANGED BALL VALVE & MOUNTING PAD.....	31-34
FULL-BORE TWO-PIECE SCREWED BALL VALVE & MOUNTING PAD.....	35-36
FULL-BORE THREE-PIECE BALL VALVE.....	37-40
FULL-BORE THREE-PIECE BALL VALVE WITH MOUNTING PAD.....	41-48
FULL-BORE THREE-PIECE SANITARY CLAMP BALL VALVE.....	49-50
FULL-BORE THREE-PIECE LONG TYPE BUTT WELD BALL VALVE.....	51-54
FULL-BORE THREE-PIECE FLANGED BALL VALVE.....	55-56
FULL-BORE THREE-PIECE FLANGED BALL VALVE & MOUNTING PAD.....	57-58
FULL-BORE THREE-PIECE CHECK VALVE.....	59-60
REDUCE PORT THREE-WAY SCREWED BALL VALVE.....	61-68
Y-TYPE STRAINER.....	69-70

# REDUCE PORT ONE PIECE SCREWED BALL VALVE SBSA-1K



## SBSA-1K DN8~DN50(1/4"~2")

REDUCE PORT ONE PIECE SCREWED BALL VALVE

- Blow-out-proof stem design
- Working pressure: **1000psi (PN 63bar)**
- Applicable temperature: **-20 to 180°C**
- Padlock device
- Pipe thread reference: **ANSI B1. 20. 1 (NPT)**  
**DIN259/DIN2999**  
**ISO228**  
**BSP**  
**PT**

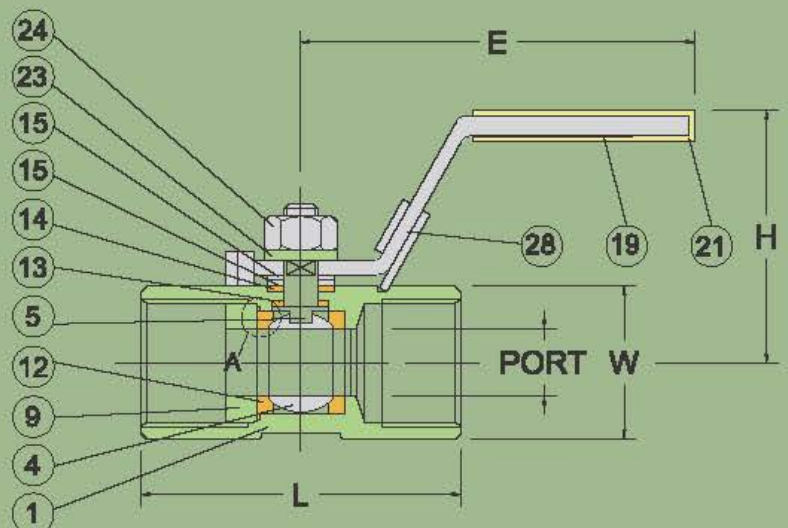
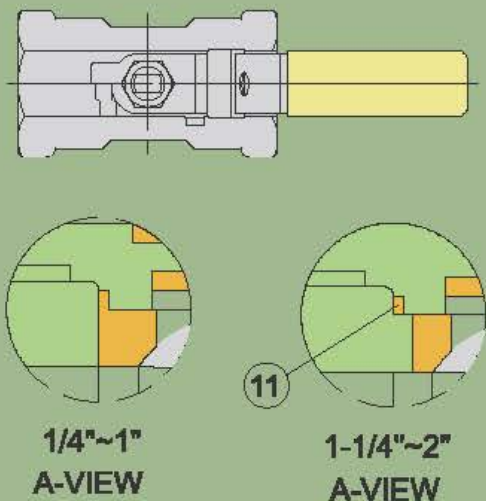



## MATERIALS LIST

NO.	PART NAME	MATERIAL
1	BODY	ASTM A351 Gr.CF8M
4	BALL	SS316/CF8M
5	STEM	SS316
9	INSERT	ASTM A351 Gr.CF8M
11	BODY SEAL	PTFE.
12	SEAT	PTFE.
13	THRUST WASHER	PTFE.
14	STEM PACKING	PTFE.
15	GLAND	SS304
19	HANDLE	SS304
21	HANDLE COVER	PLASTIC
23	HANDLE WASHER	SS304
24	HANDLE NUT	SS304
28	LOCKING DEVICE	SS304

## DIMENSIONS

unit:mm

SIZE		PORT	L	E	H	W
DN8	1/4"	5.0	39.0	69.0	35.0	17.0
DN10	3/8"	7.2	44.0	79.0	38.0	21.0
DN15	1/2"	9.2	56.5	109.0	40.0	25.0
DN20	3/4"	12.5	59.0	109.0	42.0	32.0
DN25	1"	15.0	71.0	111.7	47.0	38.0
DN32	1-1/4"	20.0	78.0	111.7	53.0	48.0
DN40	1-1/2"	25.0	83.0	157.0	62.0	53.0
DN50	2"	32.0	100.0	155.5	67.0	64.0



# REDUCE PORT ONE PIECE SCREWED BALL VALVE SBSA-1H



## SBSA-1H DN8~DN50(1/4"~2") REDUCE PORT ONE PIECE SCREWED BALL VALVE

- Blow-out-proof stem design
- Working pressure: **1000psi (PN 63bar)**
- Applicable temperature: **-20 to 180°C**
- Pipe thread reference: **ANSI B1.20.1(NPT)  
DIN 259/DIN 2999  
ISO 228  
BSP  
PT**

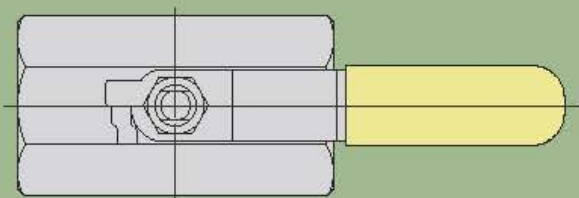

**1/4"~1"  
A-VIEW**

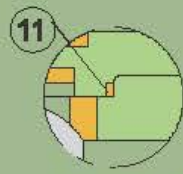

**1-1/4"~2"  
A-VIEW**

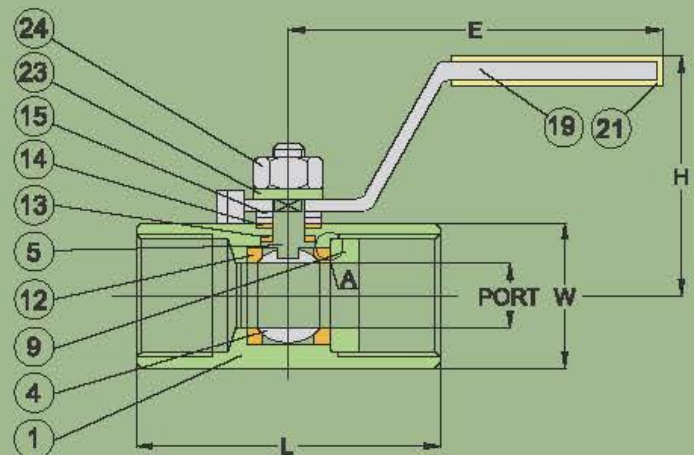

## MATERIALS LIST

NO.	PART NAME	MATERIAL
1	BODY	ASTM A351 Gr.CF8M
4	BALL	SS316/CF8M
5	STEM	SS316
9	INSERT	ASTM A351 Gr.CF8M
11	BODY SEAL	PTFE.
12	SEAT	PTFE.
13	THRUST WASHER	PTFE.
14	STEM PACKING	PTFE.
15	GLAND WASHER	SS304
19	HANDLE	SS304
21	HANDLE COVER	PLASTIC
23	SPRING WASHER	SS304
24	HANDLE NUT	SS304

## DIMENSIONS

unit:mm

SIZE		PORT	L	E	H	W
DN8	1/4"	5.0	39.0	70.0	30.5	17.0
DN10	3/8"	7.2	44.0	81.5	31.0	21.0
DN15	1/2"	9.2	56.5	97.0	47.0	25.0
DN20	3/4"	12.5	59.0	97.0	51.0	32.0
DN25	1"	15.0	71.0	101.0	52.0	38.0
DN32	1-1/4"	20.0	78.0	101.0	57.0	48.0
DN40	1-1/2"	25.0	83.0	146.0	66.5	53.0
DN50	2"	32.0	98.0	146.0	71.5	64.0

# REDUCE PORT ONE PIECE SCREWED BALL VALVE SBSA-1HV



## SBSA-1HV DN8~DN25(1/4"~1") REDUCE PORT ONE PIECE SCREWED BALL VALVE

- Blow-out-proof stem design
- Working pressure: **1000psi (PN 63bar)**
- Applicable temperature: **-20 to 180°C**
- Pipe thread reference: **ANSI B1. 20. 1 (NPT)  
DIN259/DIN2999  
ISO228  
BSP  
PT**

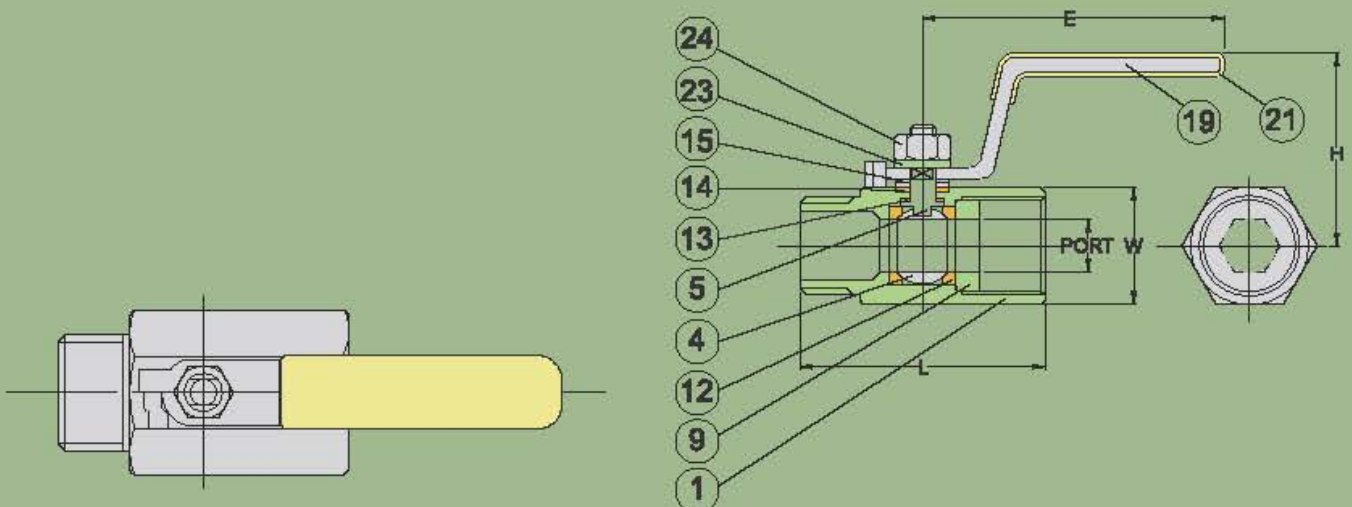



## MATERIALS LIST

NO.	PART NAME	MATERIAL
1	BODY	ASTM A351 Gr.CF8M
4	BALL	SS316/CF8M
5	STEM	SS316
9	INSERT	ASTM A351 Gr.CF8M
11	BODY SEAL	PTFE.
12	SEAT	PTFE.+15%G.F.
13	THRUST WASHER	PTFE.
14	STEM PACKING	PTFE.
15	GLAND BUSHING	SS304
19	HANDLE	SS304
21	HANDLE COVER	PLASTIC
23	SPRING WASHER	SS304
24	HANDLE NUT	SS304

## DIMENSIONS

unit:mm

SIZE		PORT	L	E	H	W
DN8	1/4"	5.0	46.0	70.0	27.0	16.0
DN10	3/8"	7.2	51.0	81.0	28.5	21.5
DN15	1/2"	9.2	59.0	96.0	44.5	24.5
DN20	3/4"	12.5	62.5	96.0	48.0	32.0
DN25	1"	15.0	76.8	103.0	53.0	38.0



**JDV  
CONTROL  
VALVES**

## REDUCE PORT ONE PIECE SCREWED BALL VALVE SBSA-1HC



### SBSA-1HC DN8~DN50(1/4"~2") REDUCE PORT ONE PIECE SCREWED BALL VALVE

- Blow-out-proof stem design
- Working pressure: **DN8~DN25 2000psi**  
**DN32~DN50 1500psi**
- Applicable temperature: **-20 to 180°C**
- Pipe thread reference: **ANSI B1. 20. 1 (NPT)**  
**DIN259/DIN2999**  
**ISO228**  
**BSP**  
**PT**

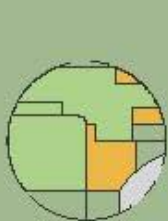
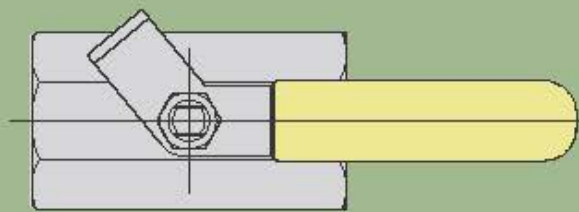

1/4"~1"  
A-VIEW

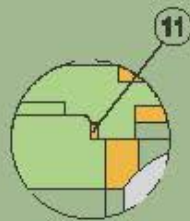

1-1/4"~2"  
A-VIEW

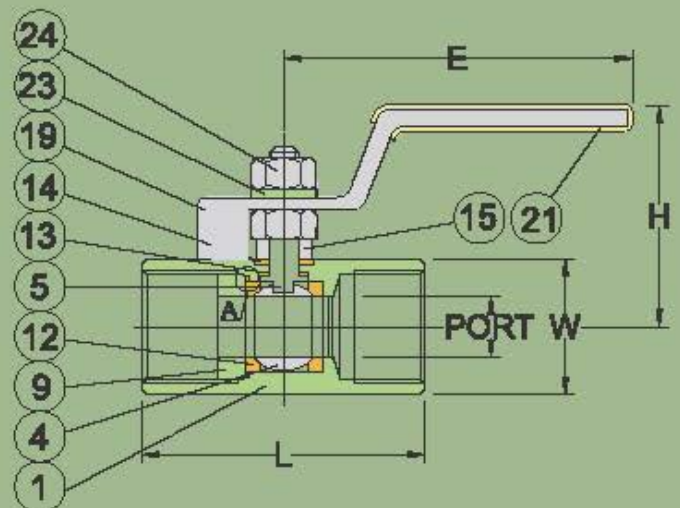



## MATERIALS LIST

NO.	PART NAME	MATERIAL
1	BODY	ASTM A351 Gr.CF8M
4	BALL	SS316/CF8M
5	STEM	SS316
9	INSERT	ASTM A351 Gr.CF8M
11	BODY SEAL	PTFE.
12	SEAT	PTFE.+15%G.F.
13	THRUST WASHER	PTFE.
14	STEM PACKING	PTFE.
15	GLAND BUSHING	SS304
19	HANDLE	SS304
21	HANDLE COVER	PLASTIC
23	SPRING WASHER	SS304
24	HANDLE NUT	SS304

## DIMENSIONS

unit:mm

SIZE		PORT	L	E	H	W
DN8	1/4"	5.0	41.3	61.0	29.5	21.0
DN10	3/8"	7.2	46.0	79.0	34.5	23.0
DN15	1/2"	9.2	57.2	108.0	58.0	29.0
DN20	3/4"	12.5	65.1	110.0	65.0	35.0
DN25	1"	15.0	76.2	122.0	68.0	41.0
DN32	1-1/4"	20.0	92.1	145.0	79.5	55.0
DN40	1-1/2"	24.5	98.4	148.0	84.0	57.0
DN50	2"	32.0	114.3	148.0	92.5	73.5



# REDUCE PORT ONE PIECE SCREWED BALL VALVE SBSA-1T



## SBSA-1T DN8~DN50(1/4"~2") REDUCE PORT ONE PIECE SCREWED BALL VALVE

- Blow-out-proof stem design
- Working pressure: **1000psi (PN 63bar)**
- Applicable temperature: **-20 to 180°C**
- Pipe thread reference: **ANSI B1. 20. 1 (NPT)  
DIN259/DIN2999  
ISO228  
BSP  
PT**

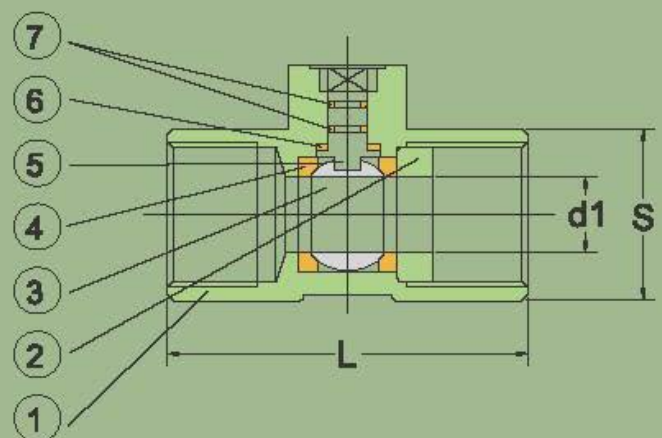
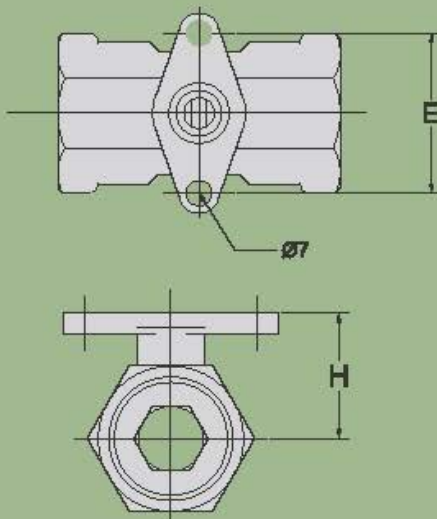

### MATERIALS LIST

NO.	PART	MATERIAL	Q,TY
1	BODY	SUS 316	1
2	CAP	SUS 316	1
3	BALL	SUS 316	1
4	SEAP	PTFE	1
5	THRUST WASHER	PTFE	1
6	STEM	SUS 316	1
7	O RING	VITON	2

### DIMENSIONS

unit:mm

SIZE	d1	L	H	E	S
1/4"	5.0	39.0	26.0	38.5	17
3/8"	7.2	44.0	27.0	38.5	19
1/2"	9.2	56.5	26.5	38.5	25
3/4"	12.5	59.0	28.5	38.5	32
1"	15.0	71.0	32.5	38.5	38
1-1/4"	20.0	78.0	36.0	38.5	49
1-1/2"	25.0	83.0	41.5	38.5	53
2"	32.0	100	47.0	38.5	64



**JDV  
CONTROL  
VALVES**

## REDUCE PORT ONE PIECE SCREWED BALL VALVE SBSA-1TB



### **SBSA-1TB DN8~DN50(1/4"~2")** REDUCE PORT ONE PIECE SCREWED BALL VALVE

- Blow-out-proof stem design
- Working pressure: **1000psi (PN 63bar)**
- Applicable temperature: **-20 to 180°C**
- Pipe thread reference: **ANSI B1. 20. 1 (NPT)**  
**DIN259/DIN2999**  
**ISO228**  
**BSP**

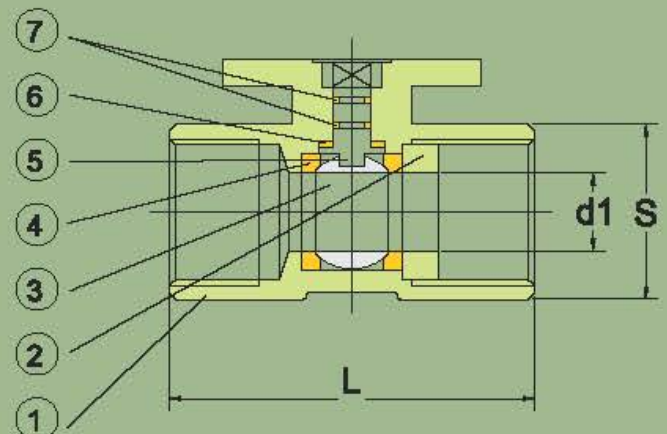
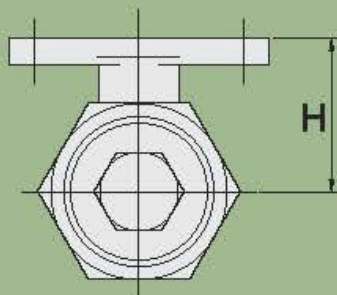
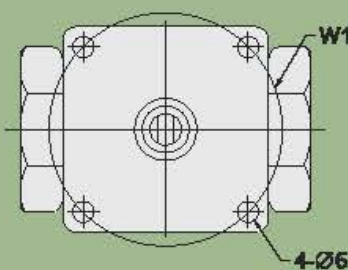



## MATERIALS LIST

NO.	PART	MATERIAL	Q,TY
1	BODY	SUS 316	1
2	CAP	SUS 316	1
3	BALL	SUS 316	1
4	SEAP	PTFE	1
5	THRUST WASHER	PTFE	1
6	STEM	SUS 316	1
7	O RING	VITON	2

## DIMENSIONS

unit:mm

SIZE	d1	L	H	E	S
1/4"	5.0	39.0	25.6	38	17
3/8"	7.2	44.0	26.7	38	21
1/2"	9.2	57.0	26.3	38	25
3/4"	12.5	58.7	29.0	38	32
1"	15.0	71.0	32.5	38	38
1-1/4"	20.0	78.0	45.0	38	49
1-1/2"	25.0	83.0	47.0	38	53
2"	32.0	100	53.2	38	65

## REDUCE PORT ONE PIECE SCREWED BALL VALVE SBSA-1 102



### SBSA-1 102 DN15~DN50(1/2"~2") REDUCE PORT ONE PIECE SCREWED BALL VALVE

- Blow-out-proof stem design
- Working pressure: **DN15~DN25 2000psi**  
**DN32~DN50 1500psi**
- Applicable temperature: **-20 to 180°C**
- Padlock device
- Pipe thread reference: **ANSI B1. 20. 1 (NPT)**  
**DIN259/DIN2999**  
**ISO228**  
**BSP**  
**PT**

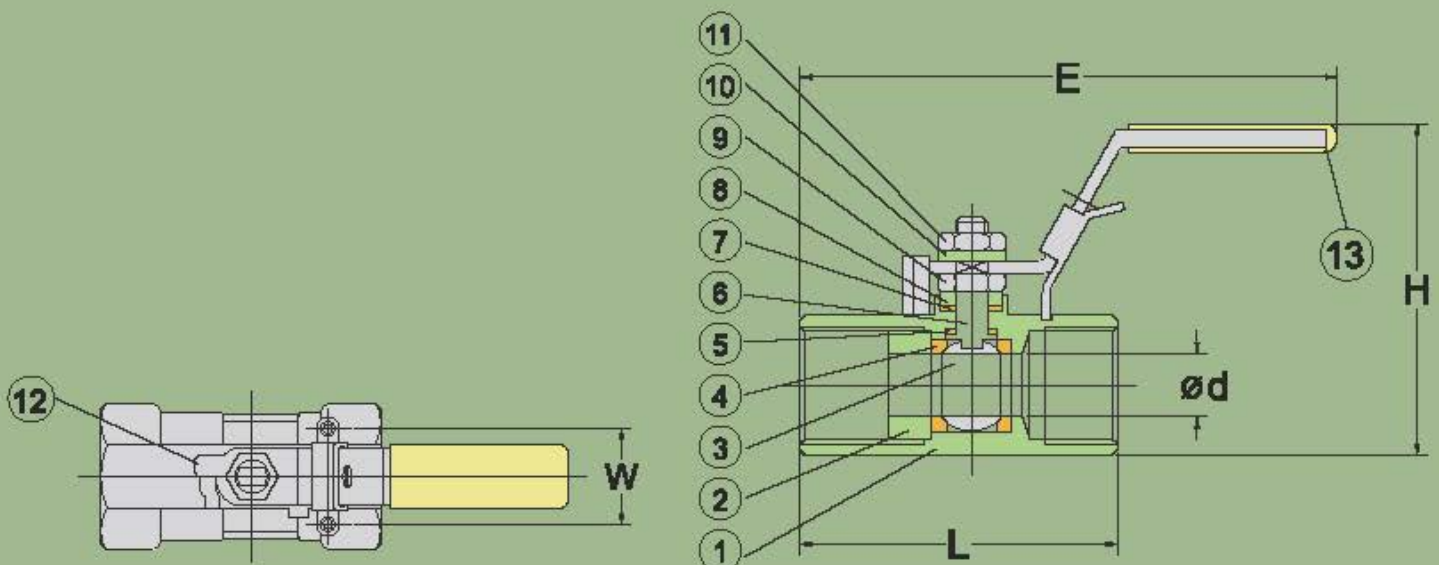

## MATERIALS LIST

NO.	PART	MATERIAL
1	BODY	CF8M
2	CAP	SUS 316
3	BALL	SUS 316
4	SEAT	RTFE
5	THRUST WASHER	PTFE
6	STEM	SUS 316
7	STEM PACKING	PTFE
8	GLAND BUSH	SUS.304
9	NUT	SUS 304
10	SPRNG WASHER	SUS 304
11	NUT	SUS 304
12	HANDLE	SUS 304
13	HANDLE SLEEVE	PLASTIC

## DIMENSIONS

unit:mm

SIZE	d	L	H	E	W
1/2"	9.2	65	49	90	28
3/4"	12.5	70	52	90	35
1"	15.0	80	54	110	35
1-1/4"	20.0	95	64	110	38
1-1/2"	25.0	100	68	140	38
2"	32.0	114	75	140	38

# REDUCE PORT ONE PIECE SCREWED BALL VALVE SBSA-1B



## SBSA-1B DN8~DN50(1/4\"/> REDUCE PORT ONE PIECE SCREWED BALL VALVE

- Blow-out-proof stem design
- Working pressure: **DN8~DN25 1000psi**
- Applicable temperature: **-20 to 180°C**
- Padlock device
- Pipe thread reference: **ANSI B1. 20. 1 (NPT)  
DIN259/DIN2999  
ISO228  
BSP  
PT**

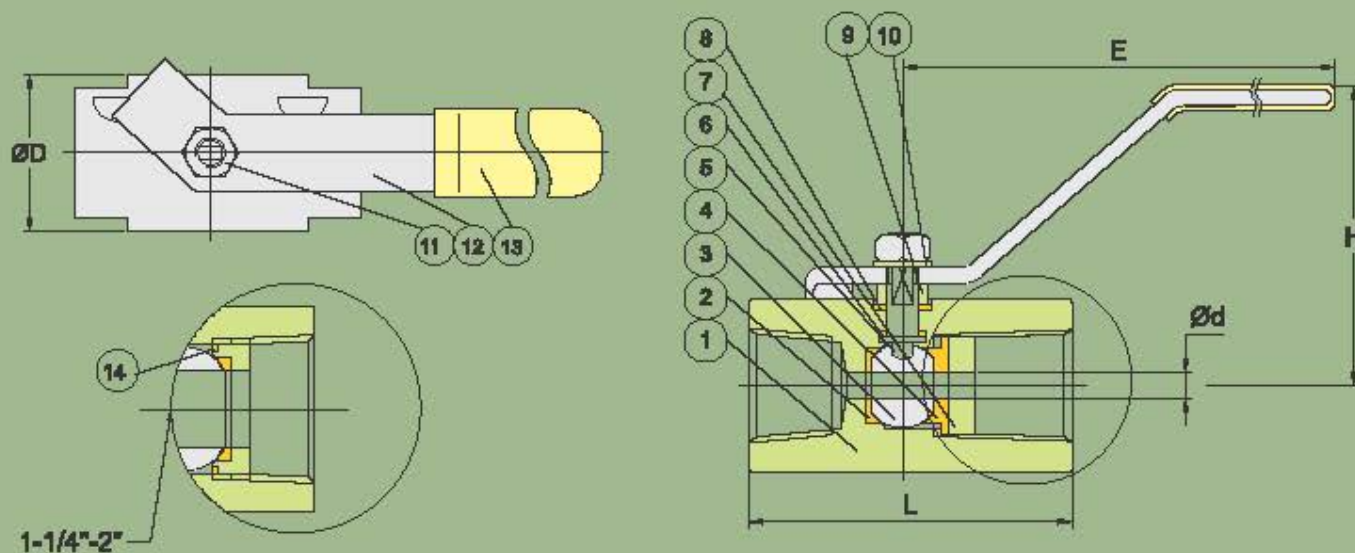



## MATERIALS LIST

NO.	PART	MATERIAL
1	BODY	CF8M
2	SEAT	PTFE
3	BALL	SUS316
4	SEAT2	PTFE
5	STEM	SUS316
6	THRUST WASHER	PTFE
7	INSERT	SUS316
8	STEM SEAL	PTFE
9	WASHER	SUS304
10	CONICAL SPRING WASHER	SUS304
11	NUT	SUS304
12	LEVER HANDLE	SUS304
13	HANDLE SLEEVE	VINYL GRIP
14	SEAT3	PTFE

## DIMENSIONS

unit:mm

SIZE	D	d	E	L	H
1/4"	30	9.5	110	60	55
3/8"	30	9.5	110	60	56
1/2"	32	9.2	110	60	55
3/4"	38	12.5	120	67	58
1"	45	17	148	76	67
1-1/4"	55	21	146	80	72
1-1/2"	65	25	150	98	80
2"	75	32	150	112	85

# FULL-BORE ONE-PIECE PN16/CLASS 150 FLANGED BALL VALVE SBBA-1FPN / SBBA-1F15



DN125-DN150:

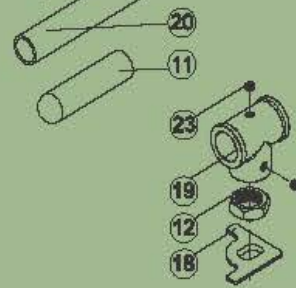

DN32-DN100:

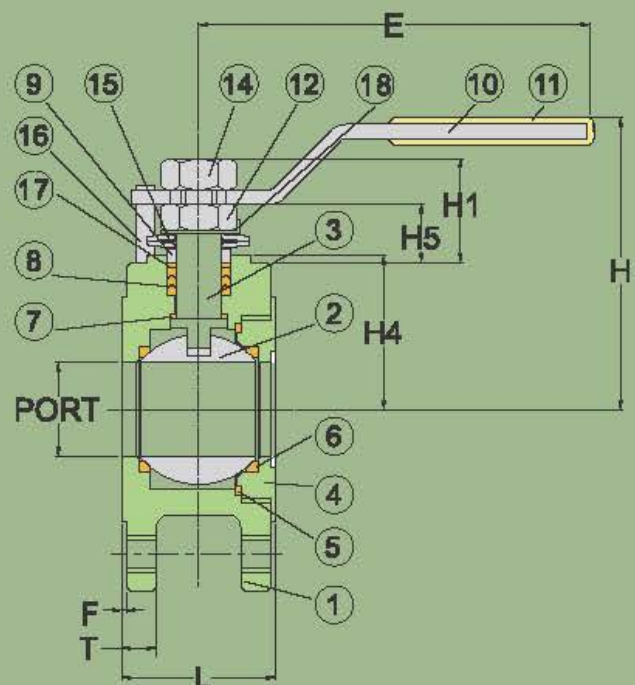
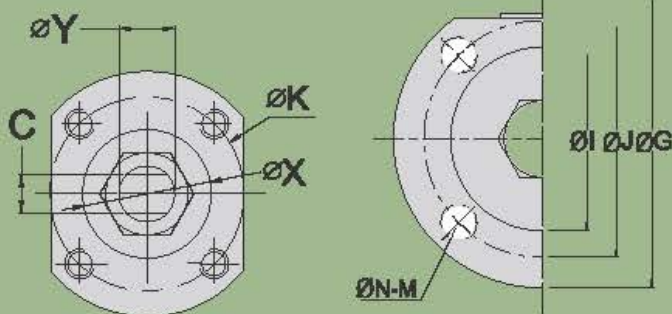
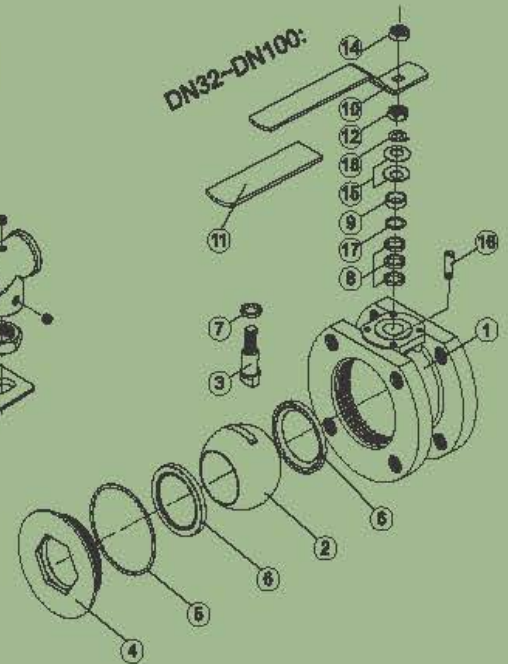

## MATERIALS LIST

NO.	PART NAME	PN16 MATERIAL		CLASS 150# MATERIAL
		1.4408 / EN 1503-1	1.0819 / EN 1503-1	CF8M,CF8(1.4408)
1	BODY	1.4408 / EN 1503-1	1.0819 / EN 1503-1	CF8M,CF8(1.4408)
2	BALL	CF8M	CF8	CF8M
3	STEM	SS316	SS304	AISI 316
4	INSERT CAP	1.4408 / EN 1503-1	1.0819 / EN 1503-1	CF8M,CF8(1.4408)
5	BODY SEAL	PTFE.		PTFE.
6	SEAT	RTFE.		RTFE.
7	THRUST WASHER	PTFE.		PTFE.
8	STEM PACKING	PTFE.		PTFE.
9	GLAND	SS304		AISI 304
10	HANDEL	SS304		AISI 304
11	HANDEL COVER	PLASTIC		PLASTIC
12	STEM NUT	SS304		AISI 304
14	HANDEL NUT	SS304		AISI 304
15	BELLEVILLE WASHER	SS301		AISI 301
16	STOP PIN	SS304		AISI 304
17	HANDLE SLEEVE	PLATIC		PLATIC
18	STOP BOLT	SS304		AISI 304
19	HANDLE ADAPTER	CF8		CF8
20	HANDLE	STEEL		STEEL
21	PACKING FOLLWER	PTFE.+25%G.F.		PTFE.+25%G.F.
22	TAB WASHER	SS304		AISI 304
23	SET BOLT	SS304		AISI 304

## DIMENSIONS

unit:mm

### DIN PN 16

SIZE	PORT	L	E	H	H1	H4	H5	C	ØX	ØY	ØG	ØJ	ØI	T	F	ØK	N	
DN15	1/2"	15	35	118	70	19.2	32	10.5	6.35	25	9.8	95	65	45	7.0	2	38	M12
DN20	3/4"	20	38	116	74	16.5	38	7.5	6.35	25	9.6	105	75	58	7.0	2	36	M12
DN25	1"	25	44	165	75	17.5	42	7.5	6.35	25	9.8	115	85	65	7.5	2	36	M12
DN32	1-1/4"	32	54	165	87	24.0	50	12.0	8.0	32	11.2	140	100	78	17.0	2	42	M16
DN40	1-1/2"	38	62	183	90	24.0	54	12.0	8.0	35	11.2	150	110	88	19.0	2	50	M16
DN50	2"	50	80	183	99	24.0	62	12.0	8.0	35	11.2	165	125	102	19.5	2	50	M16
DN65	2-1/2"	64	101	235	141	25.5	82	14.5	9.5	53	16	185	145	122	17.0	2	70	M16
DN80	3"	76	118	235	150	25.5	91	14.5	9.5	53	16	200	160	138	20.0	3.0	70	M16
DN100	4"	96	150	266	172	49.0	107	24.0	17	55	28	220	180	158	21.0	3.0	102	M16
DN125	5"	118	179	400	205	50.0	117	31.0	17	55	28	250	210	188	22.0	3.0	102	M16
DN150	6"	135	202	600	220	50.0	130	31.0	17	60	28	285	240	212	22.0	3.0	125	M20

### ANSI CLASS 150

SIZE	DN	ISO-5211	L	E	H	H1	H4	H5	C	ØY	ØG	ØJ	ØI	T	F	ØK	ØN
1/2"	15	F03	35	118	70	19.2	32	10.5	6.35	9.6	88.9	60.5	35.1	7.0	1.6	38	1/2"
3/4"	20	F03	38	116	74	16.5	38	7.5	6.35	9.6	98.6	69.9	42.9	7.0	1.6	36	1/2"
1"	25	F03	44	165	75	17.5	42	7.5	6.35	9.6	108.0	79.2	50.8	7.5	1.6	36	1/2"
1-1/4"	32	F04	54	165	87	24.0	50	12.0	8.0	11.2	117.3	88.9	64.0	15.9	1.6	42	5/8"
1-1/2"	40	F05	62	183	90	24.0	54	12.0	8.0	11.2	127.0	98.6	73.2	17.5	1.6	50	5/8"
2"	50	F05	80	183	99	24.0	62	12.0	8.0	11.2	152.4	120.7	81.9	19.1	1.6	50	5/8"
2-1/2"	65	F07	101	235	141	25.5	82	14.5	9.5	16.0	177.8	139.7	104.6	22.3	1.6	70	5/8"
3"	80	F07	118	235	150	25.5	91	14.5	9.5	28.0	190.5	152.4	127.0	23.9	1.6	70	5/8"
4"	100	F10	150	266	172	49.0	107	24.0	17.0	28.0	228.6	190.5	157.2	23.9	1.6	102	5/8"



# FULL-BORE TWO-PIECE SCREWED BALL VALVE SBSC-2A



## SBSC-2A DN8~DN80(1/4"~3") FULL-BORE TWO-PIECE SCREWED BALL VALVE

- Blow-out-proof stem design
- Working pressure: **DN8~DN50 1000psi**  
**DN65~DN80 800psi**
- Applicable temperature: **-20 to 180°C**
- Padlock device
- Pipe thread reference: **ANSI B1. 20. 1 (NPT)**  
**DIN259/DIN2999**  
**ISO228**  
**BSP**  
**PT**

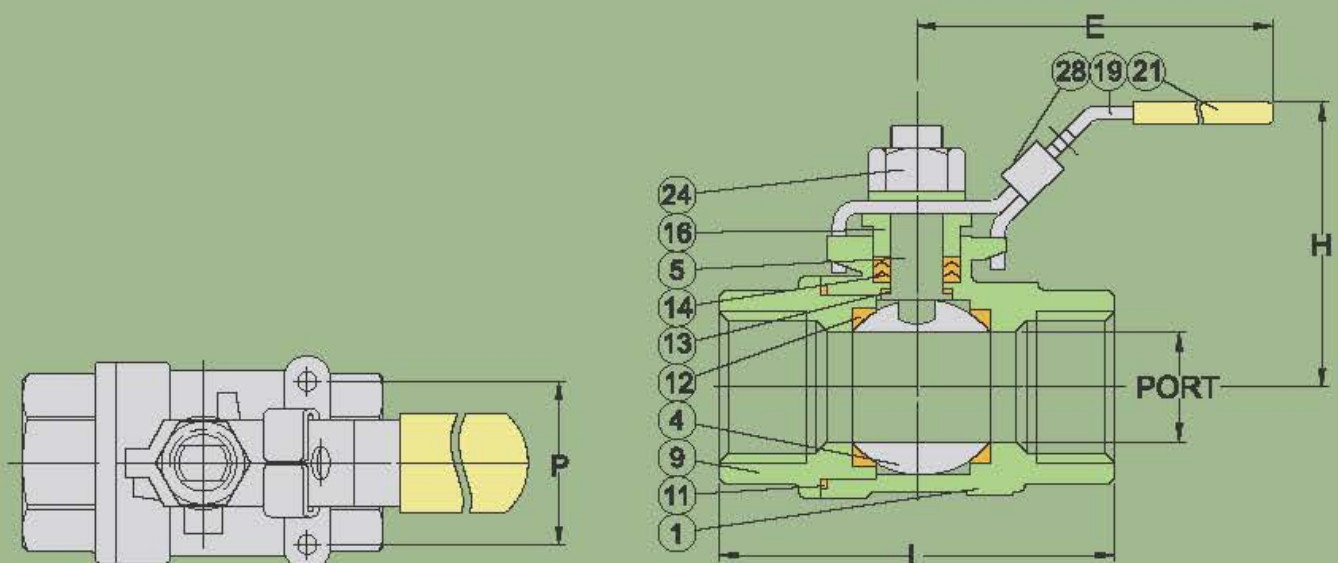



## MATERIALS LIST

NO.	PART NAME	MATERIAL
1	BODY	ASTM A351 Gr.CF8M
4	BALL	ASTM A351 Gr.CF8M
5	STEM	SS316
9	END CAP	ASTM A351 Gr.CF8M
11	BODY SEAL	PTFE.
12	SEAT	PTFE.
13	THRUST WASHER	PTFE.
14	STEM PACKING	PTFE.
16	GLAND NUT	SS304
19	HANDLE	SS304
21	HANDLE COVER	PLASTIC
24	HANDLE NUT	SS304
28	LOCKING DEVICE	SS304(OPTION)

## DIMENSIONS

unit:mm

SIZE	PORT	L	E	H	P
DN8	1/4"	11.5	54.4	103.9	28.0
DN10	3/8"	12.5	54.4	103.9	28.0
DN15	1/2"	15.0	65.3	123.0	28.0
DN20	3/4"	20.0	77.3	123.0	35.0
DN25	1"	25.0	88.7	145.0	35.0
DN32	1-1/4"	32.0	102.4	145.0	38.0
DN40	1-1/2"	38.1	109.0	189.0	38.0
DN50	2"	50.0	125.3	189.0	38.0
DN65	2-1/2"	65.0	165.0	255.0	55.0
DN80	3"	80.0	189.5	281.0	55.0

# FULL-BORE TWO-PIECE SCREWED BALL VALVE SBSC-2AM3



## SBSC-2AM3 DN8~DN80(1/4"~3")

FULL-BORE TWO-PIECE SCREWED BALL VALVE

- Blow-out-proof stem design
- Working pressure: **DN8~DN25 2000psi**  
**DN32~DN50 1500psi**  
**DN65~DN80 1000psi**
- Applicable temperature: **-20 to 180°C**
- Padlock device
- Length: **DIN 3202 M3**
- Pipe thread reference: **ANSI B1. 20. 1 (NPT)**  
**DIN259/DIN2999**  
**ISO228**  
**BSP**  
**PT**

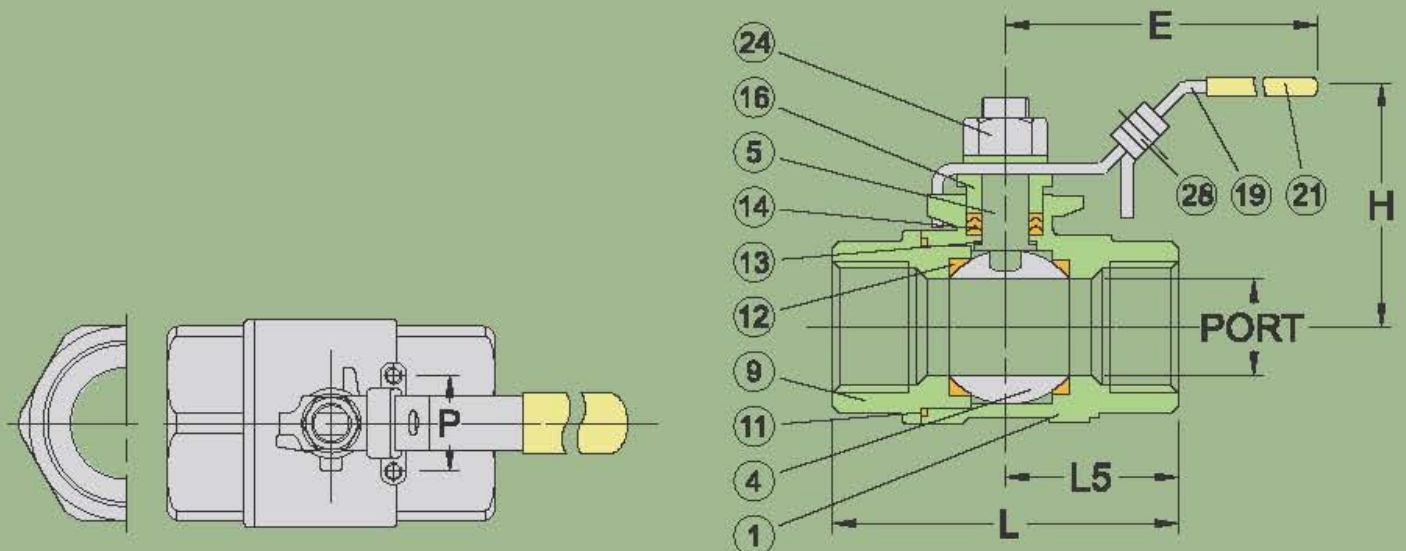

## MATERIALS LIST

NO.	PART NAME	MATERIAL
1	BODY	ASTM A351 Gr.CF8M
4	BALL	ASTM A351 Gr.CF8M
5	STEM	SS316
9	END CAP	ASTM A351 Gr.CF8M
11	BODY SEAL	PTFE.
12	SEAT	PTFE.
13	THRUST WASHER	PTFE.
14	STEM PACKING	PTFE.
18	GLAND NUT	SS304
19	HANDLE	SS304
21	HANDLE COVER	PLASTIC
24	HANDLE NUT	SS304
28	LOCKING DEVICE	SS304(OPTION)

## DIMENSIONS

unit:mm

SIZE		PORT	L	L5	E	H	P
DN8	1/4"	11.5	60.0	28.2	97.4	50.0	28.5
DN10	3/8"	12.5	60.0	28.2	97.4	50.0	28.5
DN15	1/2"	15.0	75.0	35.7	123.0	58.8	28.5
DN20	3/4"	20.0	90.0	40.2	123.0	62.5	35.0
DN25	1"	25.0	90.0	45.0	145.0	69.3	35.0
DN32	1-1/4"	32.0	110.0	53.4	145.0	76.0	38.0
DN40	1-1/2"	38.0	120.0	60.0	189.0	86.9	38.0
DN50	2"	50.0	140.0	69.5	189.0	95.0	38.0
DN65	2-1/2"	65.0	185.0	91.5	255.0	131.3	55.0
DN80	3"	80.0	205.0	102.7	261.0	140.6	55.0

# FULL-BORE TWO-PIECE SCREWED BALL VALVE SBSC-2D



## SBSC-2D DN8~DN80(1/4"~3")

FULL-BORE TWO-PIECE SCREWED BALL  
VALVE & MOUNTING PAD

- ISO 5211 mounting pad
- Blow-out-proof stem design
- Working pressure: **1000psi**
- Applicable temperature: **-20 to 180°C**
- Padlock device
- Pipe thread reference: **ANSI B1. 20. 1 (NPT)**  
**DIN259/DIN2999**  
**ISO228**  
**BSP**  
**PT**

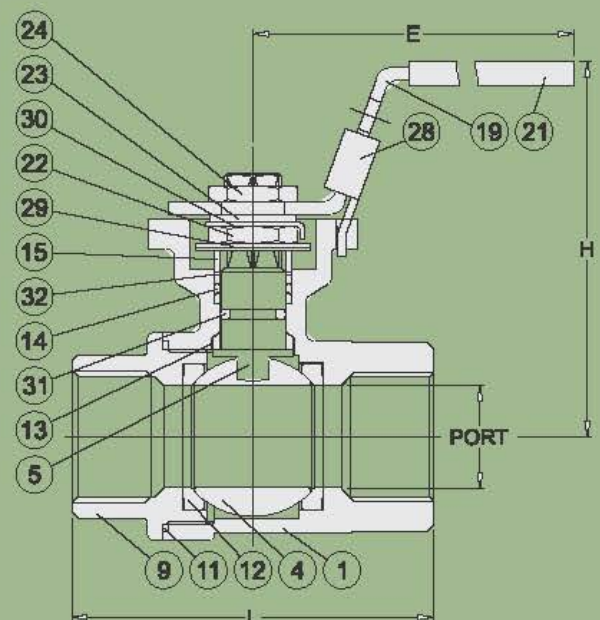
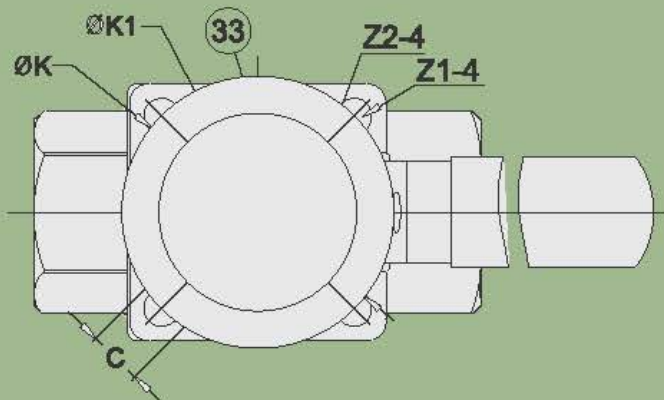



## MATERIALS LIST

NO.	PART NAME	MATERIAL
1	BODY	ASTM A351 Gr.CF8M
4	BALL	ASTM A351 Gr.CF8M
5	STEM	SS316
9	END CAP	ASTM A351 Gr.CF8M
11	BODY SEAL	PTFE.
12	SEAT	PTFE.+15GG.F.
13	THRUST WASHER	PTFE.+15GG.F.
14	STEM PACKING	PTFE.+15GG.F.
15	GLAND BUSH	SS304
19	HANDLE	SS304
21	HANDLE COVER	PLASTIC
22	STEM NUT	SS304
23	HANDLE WAHSER	SS304
24	HANDLE NUT	SS304
28	LOCKING DEVICE	SS304(OPTION)
29	BELLEVILLE WASHER	SUS304-CSP
30	TAB WASHER	SS304
31	STEM O-RING	VITON
32	PACKING FOLLOWER	PTFE.+25GG.F.
33	STOP PIN	SS304

## DIMENSIONS

unit:mm

SIZE	PORT	L	E	H	C	ØK	ØK1	Z1-4	Z2-4	
DN8	1/4"	11.5	65.3	112.0	72.9	9.0	50.0	36.0	7.0	6.0
DN10	3/8"	12.5	65.3	112.0	72.9	9.0	50.0	36.0	7.0	6.0
DN15	1/2"	15.0	65.3	112.0	72.9	9.0	50.0	36.0	7.0	6.0
DN20	3/4"	20.0	77.3	112.0	81.8	9.0	50.0	36.0	7.0	6.0
DN25	1"	25.0	88.7	136.0	90.5	9.0	50.0	36.0	7.0	6.0
DN32	1-1/4"	32.0	102.4	185.0	98.0	9.0	50.0	36.0	7.0	6.0
DN40	1-1/2"	38.0	109.0	197.9	114.7	14.0	70.0	50.0	9.0	7.0
DN50	2"	50.0	125.3	197.9	124.0	14.0	70.0	50.0	9.0	7.0

# FULL-BORE TWO-PIECE SCREWED BALL VALVE SBSC-2C



## SBSC-2C DN8~DN80(1/4"~3")

FULL-BORE TWO-PIECE SCREWED BALL  
VALVE & MOUNTING PAD

- Blow-out-proof stem design
- Working pressure: **800psi**
- Applicable temperature: **-20 to 180°C**
- Padlock device
- Pipe thread reference: **ANSI B1. 20. 1 (NPT)**  
**DIN259/DIN2999**  
**ISO228**  
**BSP**  
**PT**

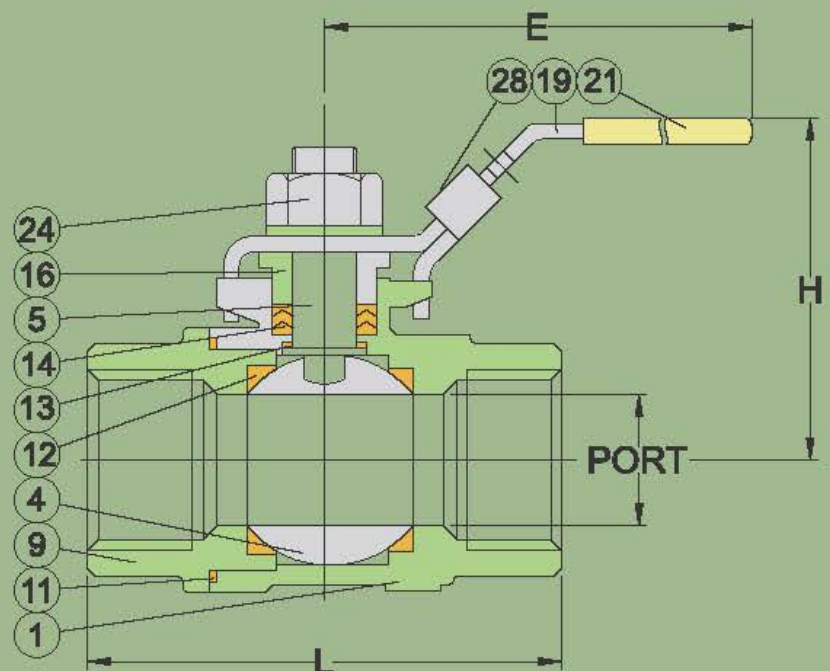

## MATERIALS LIST

NO.	PART NAME	MATERIAL
1	BODY	ASTM A351 Gr.CF8M
4	BALL	ASTM A351 Gr.CF8M
5	STEM	SS316
9	END CAP	ASTM A351 Gr.CF8M
11	BODY SEAL	PTFE.
12	SEAT	PTFE.
13	THRUST WASHER	PTFE.
14	STEM PACKING	PTFE.
16	GLAND NUT	SS304
19	HANDLE	SS304
21	HANDLE COVER	PLASTIC
24	HANDLE NUT	SS304
28	LOCKING DEVICE	SS304(OPTION)

## DIMENSIONS

unit:mm

SIZE	L	ØPORT	E	H
1/4"	46.6	11.5	75	50.0
3/8"	46.6	12.5	75	50.0
1/2"	56.3	15.0	95	56.5
3/4"	61.5	20.0	95	60.5
1"	75.5	24.0	120	68.8
1 1/4"	85.8	31.0	120	75.0
1 1/2"	94.8	37.0	150	83.5
2"	114.2	50.0	150	95.0
2 1/2"	139.8	62.0	220	127.3
3"	156.4	75.0	220	136.1



# REDUCE PORT TWO-PIECE SCREWED BALL VALVE SBSC-2AT



## SBSC-2AT DN8~DN50(1/4"~2")

TWO PIECE EXTERNAL SCREW THREAD  
BALL VALVE(SPEED REDUCTION)

- Blow-out-proof stem design
- Working pressure: **1000psi**
- Applicable temperature: **-20 to 180°C**
- Connection mode: **MALE END**
- Padlock device
- Pipe thread reference: **ANSI B1. 20. 1 (NPT)**  
**DIN259/DIN2999**  
**ISO228**  
**BSP**  
**PT**

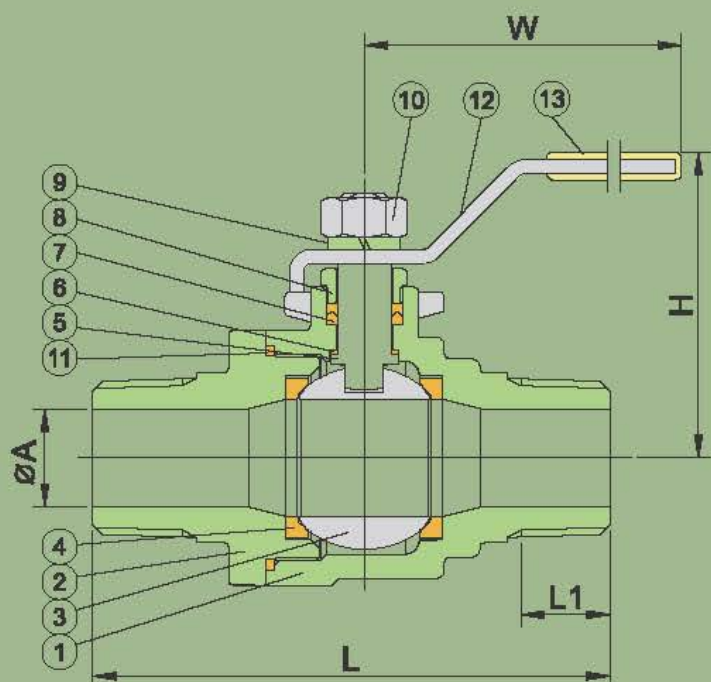



## MATERIALS LIST

NO.	PART NAME	MATERIAL	QTY
1	BODY	1.4408	1
2	END CAP	1.4408	1
3	BALL	CF8M	1
4	BALL SEAT	PTFE	2
5	STEM	SS316	1
6	THRUST WASHER	PTFE.	1
7	STEM PACKING	PTFE.	1
8	GLAND	SS304	1
9	WASHER	SS304	1
10	NUT	SS304	1
11	JOINT GASKET	PTFE	1
12	HANDLE	SS304	1
13	PLASTIC COVER	PLASTIC	1

## DIMENSIONS

unit:mm

SIZE	DN	ØA	L	L1	H	W
1/4"	8	8.5	69	12	50	104
3/8"	10	9.0	71	12	50	104
1/2"	15	11.6	79	15	56.5	123
3/4"	20	14.5	94	18	60.5	123
1"	25	20.0	106	20	69.3	145
1-1/4"	32	25.0	122	22	76	145
1-1/2"	40	32.0	142	25	84.5	189
2"	50	38.0	168	28	95	189



**JDV  
CONTROL  
VALVES**

## REDUCE PORT TWO-PIECE SCREWED BALL VALVE SBSC-2



### SBSC-2 DN8~DN50(1/4"~2")

REDUCE PORT TWO-PIECE SCREWED BALL VALVE

- Blow-out-proof stem design
- Working pressure: **2000psi**
- Applicable temperature: **-20 to 180°C**
- Padlock device
- Pipe thread reference: **ANSI B1. 20. 1 (NPT)**  
**DIN259/DIN2999**  
**ISO228**  
**PF**  
**PT**

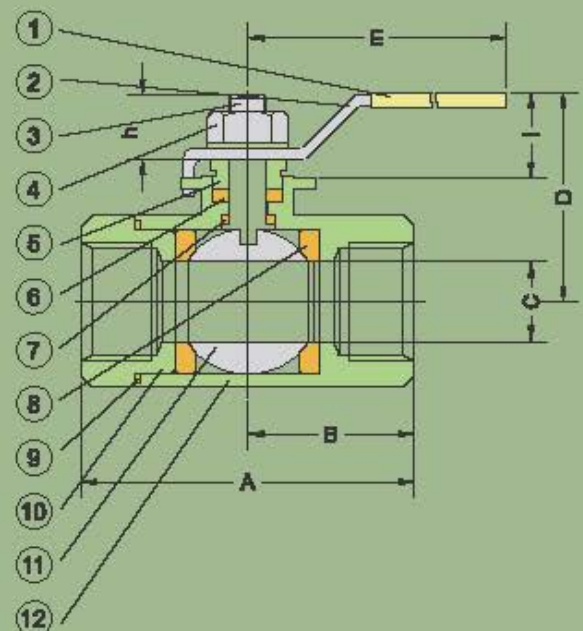
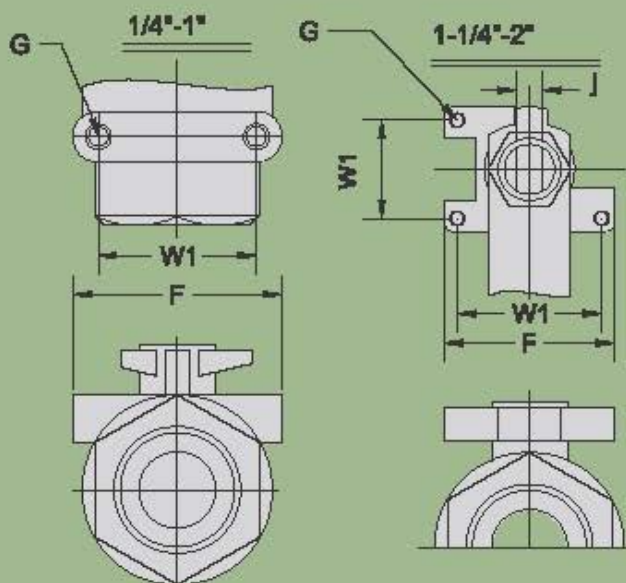

## MATERIALS LIST

NO.	PART	MATERIAL		Q.TY
		STAINLESS STEEL	CARBON STEEL	
1	HANDLE SLEEVE	VINYL GRIP	VINYL GRIP	1
2	HANDLE	SUS 304	SUS 304	1
3	STEM	SUS 316	SUS 316	1
4	HANDLE NUT	SUS 304	SUS 304	1
5	GLAND	SUS 304	SUS 304	1
6	PACKING	PTFE	PTFE	1
7	THRUST WASHER	PTFE	PTFE	1
8	SEAT	RTFE	RTFE	2
9	GASKET	PTFE	PTFE	1
10	CAP	ASTM A351 GR.CF8M	ASTM A351 GR.WCB	1
11	BALL	SUS 316	SUS 316	1
12	BODY	ASTM A351 GR.CF8M	ASTM A351 GR.WCB	1

## DIMENSIONS

unit:mm

SIZE \ DM	A	B	C	D	E	F	G	W1	h	l	J
1/4"	57	26.0	13.0	51	100	39	W3/16-24	28.2	11	35	5.2
3/8"	57	26.0	13.0	51	100	39	W3/16-24	28.2	11	35	5.2
1/2"	60	29.0	13.0	51	100	39	W3/16-24	28.2	11	35	5.2
3/4"	79	38.0	17.5	62	123	46	W3/16-24	34.7	12	42	6.2
1"	85	41.0	22.3	67	123	46	W3/16-24	34.7	12	42	6.2
1-1/4"	102	51.5	25.6	84	144	50	W1/4-20	35.6	20	40	9.3
1-1/2"	111	56.0	32.0	89	144	50	W1/4-20	35.6	20	42	9.3
2"	137	68.0	38.3	94	180	50	W1/4-20	35.6	20	40	9.3



# FULL-BORE TWO-PIECE FLANGED BALL VALVE & MOUNTING PAD SBBC-2FD



**SBBC-2FD PN16 /40 DN15~DN100 (1/2"~4")**  
**FULL-BORE TWO-PIECE PN16/PN40 FLANGED BALL VALVE & MOUNTING PAD**

- Blow-out-proof stem design
- ISO 5211 mounting pad
- Working pressure: -20 to 180°C
- Design code: EN12516-1
- Flange connection standard: EN 1092-1 TYPE 21 PN16/40(RF SF)
- Face to face: EN 558-1 F4/F5(DIN 3202 F4/F5)
- Inspection and testing: EN-12266-1

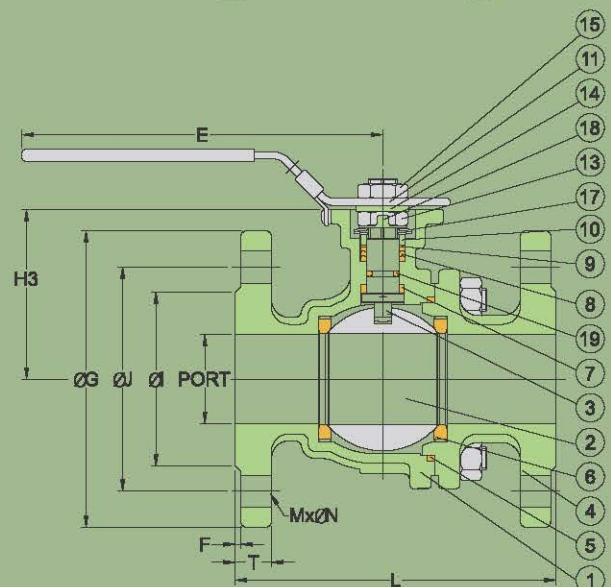
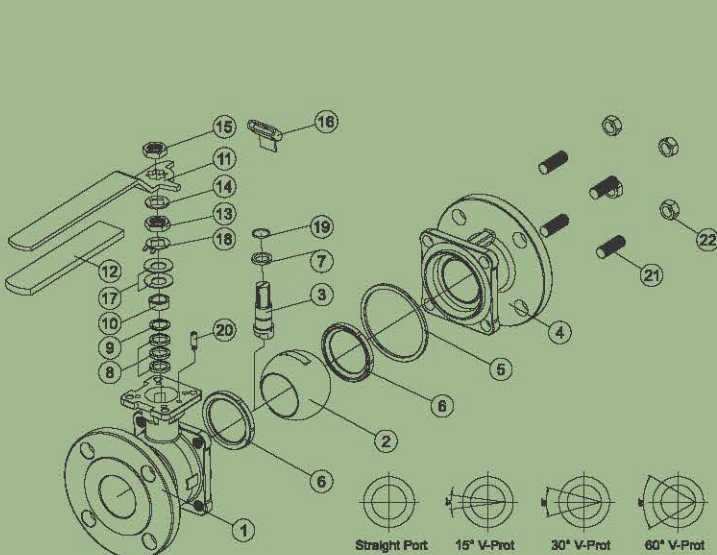
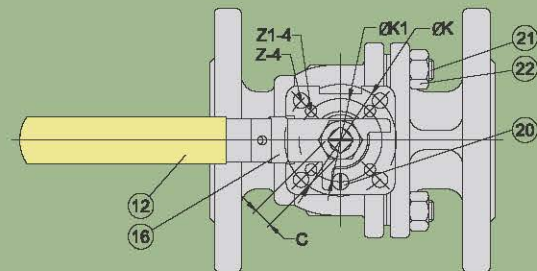



## MATERIALS LIST

SBBC-2FD 1/2"~4"

NO.	PART NAME	10K MATERIAL	PN16/40 MATERIAL		CLASS150/300 MATERIAL	
1	BODY	SCS13	1.4408	11.0619	CF8M	WCB
2	BALL	SCS13	CF8M	CF8	SS316	CF8
3	STEM	SS304	SS316	SS304	SS316	SS316
4	END CAP	SCS13	1.4408	1 1.0619	CF8M	WCB
5	BODY SEAL	PTFE.	PTFE.	PTFE.	PTFE.	PTFE.
6	SEAT	RTFE.	RTFE.	RTFE.	RTFE.	RTFE.
7	THRUST WASHER	RTFE.	RTFE.	RTFE.	RTFE.	RTFE.
8	STEM PACKING	RTFE.	RTFE.	RTFE.	RTFE.	RTFE.
9	THRUST WASHER	PTFE. +25%G. F.	PTFE. +25%G. F.		PTFE. +25%G. F.	
10	GLAND	SS304	SS304	SS304	SS304	SS304
11	HANDLE	SS304	SS304	SS304	SS304	SS304
12	HANDLE COVER	PLASTIC	PLASTIC	PLASTIC	PLASTIC	PLASTIC
13	STEM NUT	SS304	SS304	SS304	SS304	SS304
14	HANDLE WASHER	SS304	SS304	SS304	SS304	SS304
15	HANDLE NUT	SS304	SS304	SS304	SS304	SS304
16	LOCKING PAD	SS304	SS304	SS304	SS304	SS304
17	BELLEVILLE WASHER	SS304	SS304	SS304	SS304	SS304
18	STOP WASHER	SS304	SS304	SS304	SS304	SS304
19	STEM O-RING	VITON	VITON	VITON	VITON	VITON
20	STOP	SS304	SS304	SS304	SS304	SS304
21	STUD	A193 Gr.B8	A193 Gr.B8	A193 Gr.B8	A193 Gr.B8	A193 Gr.B8
22	NUT	A194 Gr.8	A194 Gr.8	A194 Gr.8	A194 Gr.8	A194 Gr.8

## DIMENSIONS

unit:mm

SBBC-2FD 1/2"~4" PN16

SIZE	PORT	L	E	H2	H3	C	ØG	ØJ	ØI	T	F	M	ØN	ØK	ØK1	Z-4	Z1-4	
DN15	1/2"	15.0	115.0	112	8.5	48	9.0	95.0	65.0	45.0	16.0	2.0	4	14.0	50.0	36.0	7.0	6.0
DN20	3/4"	20.0	120.0	112	8.5	62	9.0	105.0	75.0	58.0	18.0	2.0	4	14.0	50.0	36.0	7.0	6.0
DN25	1"	25.0	125.0	136	11.4	64	9.0	115.0	85.0	68.0	18.0	2.0	4	14.0	50.0	36.0	7.0	6.0
DN32	1-1/4"	32.0	130.0	185	11.4	71	9.0	140.0	100.0	78.0	18.0	2.0	4	18.0	50.0	36.0	7.0	6.0
DN40	1-1/2"	38.0	140.0	198	14.0	76	14.0	150.0	110.0	88.0	18.0	2.0	4	18.0	70.0	50.0	9.0	7.0
DN50	2"	50.0	150.0	198	13.7	84.5	14.0	165.0	125.0	102.0	20.0	2.0	4	18.0	70.0	50.0	9.0	7.0
DN65	2-1/2"	64.0	170.0	265	18.0	106.8	17.0	185.0	145.0	122.0	18.0	2.0	4	18.0	102.0	70.0	11.0	9.0
DN80	3"	76.0	180.0	265	18.0	116.0	17.0	200.0	160.0	138.0	20.0	2.0	8	18.0	102.0	70.0	11.0	9.0
DN100	4"	100.0	190.0	325	18.0	154.5	17.0	220.0	180.0	158.0	20.0	2.0	8	18.0	102.0	70.0	11.0	9.0

SBBC-2FD 1/2"~4" PN40

SIZE	PORT	L	E	H2	H3	C	ØG	ØJ	ØI	T	F	M	ØN	ØK	ØK1	Z-4	Z1-4	
DN15	1/2"	15.0	115.0	112	8.5	48	9.0	95.0	65.0	45.0	16.0	2.0	4	14.0	50.0	36.0	7.0	6.0
DN20	3/4"	20.0	120.0	112	8.5	62	9.0	105.0	75.0	58.0	18.0	2.0	4	14.0	50.0	36.0	7.0	6.0
DN25	1"	25.0	125.0	136	11.4	64	9.0	115.0	85.0	68.0	18.0	2.0	4	14.0	50.0	36.0	7.0	6.0
DN32	1-1/4"	32.0	130.0	185	11.4	71	9.0	140.0	100.0	78.0	18.0	2.0	4	18.0	50.0	36.0	7.0	6.0
DN40	1-1/2"	38.0	140.0	198	14.0	76	14.0	150.0	110.0	88.0	18.0	2.0	4	18.0	70.0	50.0	9.0	7.0
DN50	2"	50.0	150.0	198	13.7	84.5	14.0	165.0	125.0	102.0	20.0	2.0	4	18.0	70.0	50.0	9.0	7.0
DN65	2-1/2"	64.0	170.0	265	18.0	106.8	17.0	185.0	145.0	122.0	22.0	2.0	8	18.0	102.0	70.0	11.0	9.0
DN80	3"	76.0	180.0	265	18.0	116.0	17.0	200.0	160.0	138.0	24.0	2.0	8	18.0	102.0	70.0	11.0	9.0
DN100	4"	100.0	190.0	325	18.0	154.5	17.0	235.0	190.0	158.0	24.0	2.0	8	22.0	102.0	70.0	11.0	9.0

# FULL-BORE TWO-PIECE FLANGED BALL VALVE & MOUNTING PAD SBBC-2FD



## SBBC-2FD CLASS 150# 300# DN15~DN100 (1/2"~4") FULL-BORE TWO-PIECE CLASS 150/300 FLANGED BALL VALVE & MOUNTING PAD

- Blow-out-proof stem design
- ISO 5211 mounting pad
- Working pressure: -20 to 180°C
- Design code: ANSI B16.34
- Flange connection standard: ANSI B16.5 CLASS150/300
- Face to face: ANSI B16.1
- Inspection and testing: API-598

## SBBC-2FD 10K 15A~100A (1/2"~4") FULL-BORE TWO-PIECE JIS 10K FLANGED BALL VALVE & MOUNTING PAD

- Blow-out-proof stem design
- ISO 5211 mounting pad
- Working pressure: -20 to 180°C
- Design code: ANSI B16.34
- Flange connection standard: JIS B2238 10K
- Face to face: JIS B2002 (ANSI B16.1)
- Inspection and testing: API-598

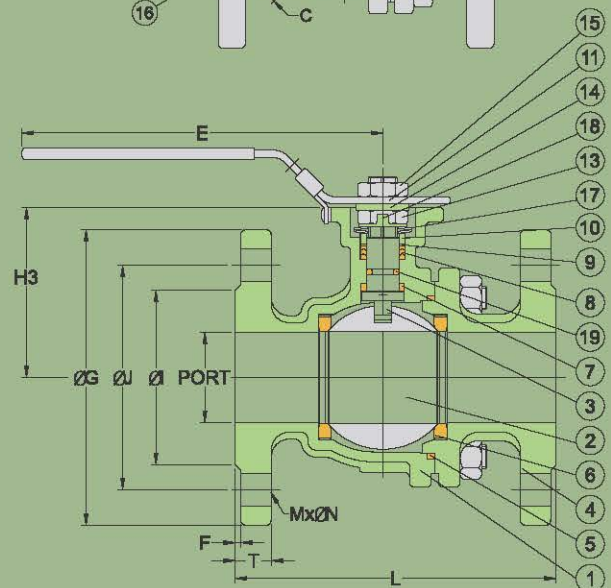
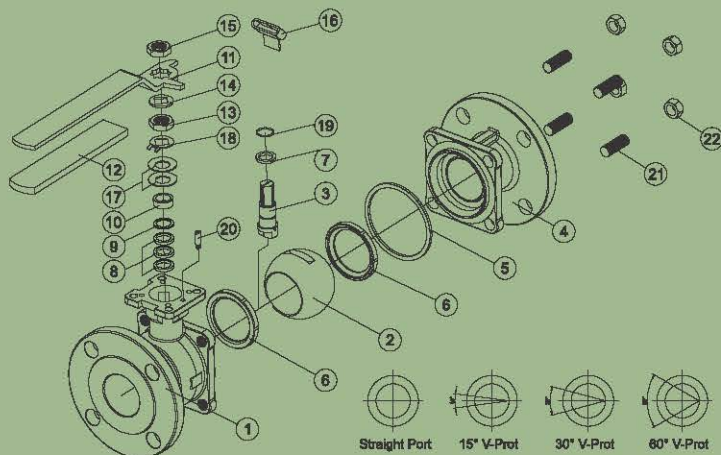
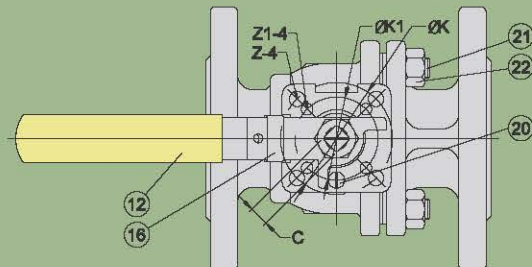



## DIMENSIONS

unit:mm

### SBBC-2FD 10K 1/2"~4"

SIZE	PORT	L	E	H2	H3	C	ØG	ØJ	ØI	T	F	M	ØN	ØK	ØK1	Z-4	Z1-4
15A	15.0	108.0	112	8.5	48	9.0	95.0	70.0	51.0	12.0	1.0	4	15.0	50.0	36.0	7.0	6.0
20A	20.0	117.0	112	8.5	62	9.0	100.0	75.0	56.0	14.0	1.0	4	15.0	50.0	36.0	7.0	6.0
25A	25.0	127.0	136	11.4	64	9.0	125.0	90.0	67.0	14.0	1.0	4	19.0	50.0	36.0	7.0	6.0
32A	32.0	140.0	185	11.4	71	9.0	135.0	100.0	76.0	16.0	2.0	4	19.0	50.0	36.0	7.0	6.0
40A	38.0	165.0	198	14.0	76	14.0	140.0	105.0	81.0	16.0	2.0	4	19.0	70.0	50.0	9.0	7.0
50A	50.0	178.0	198	13.7	84.5	14.0	155.0	120.0	96.0	16.0	2.0	4	19.0	70.0	50.0	9.0	7.0
65A	64.0	190.0	265	18.0	106.8	17.0	175.0	140.0	116.0	18.0	2.0	4	19.0	102.0	70.0	11.0	9.0
80A	76.0	203.0	265	18.0	116.0	17.0	185.0	150.0	126.0	18.0	2.0	8	19.0	102.0	70.0	11.0	9.0
100A	100.0	229.0	325	18.0	154.5	17.0	210.0	175.0	151.0	18.0	2.0	8	19.0	102.0	70.0	11.0	9.0

### SBBC-2FD 1/2"~4" CLASS150

SIZE	PORT	L	E	H2	H3	C	ØG	ØJ	ØI	T	F	M	ØN	ØK	ØK1	Z-4	Z1-4			
DN15	1/2"	15.0	108.0	112	8.5	48	9.0	89.0	60.5	35.0	11.2	1.6	4	16.0	50	F05	36	F03	7.0	6.0
DN20	3/4"	20.0	117.0	112	8.5	62	9.0	98.6	70.0	43.0	12.7	1.6	4	16.0	50	F05	36	F03	7.0	6.0
DN25	1"	25.0	127.0	136	11.4	64	9.0	108.0	79.2	51.0	14.3	1.6	4	16.0	50	F05	36	F03	7.0	6.0
DN32	1-1/4"	32.0	140.0	185	11.4	71	9.0	117.5	88.9	63.5	15.9	1.6	4	16.0	50	F05	36	F03	7.0	6.0
DN40	1-1/2"	38.0	165.0	198	14.0	76	14.0	127.0	98.6	73.2	17.5	1.6	4	16.0	70	F07	50	F05	9.0	7.0
DN50	2"	50.0	178.0	198	13.7	84.5	14.0	152.5	120.7	92.0	19.1	1.6	4	19.0	70	F07	50	F05	9.0	7.0
DN65	2-1/2"	64.0	190.0	265	18.0	106.8	17.0	177.8	139.7	104.7	23.3	1.6	4	19.0	102	F10	70	F07	11.0	9.0
DN80	3"	76.0	203.0	265	18.0	116.0	17.0	190.5	152.4	127.0	23.9	1.6	4	19.0	102	F10	70	F07	11.0	9.0
DN100	4"	100.0	229.0	325	18.0	154.5	17.0	228.8	190.5	157.2	23.9	1.6	8	19.0	102	F10	70	F07	11.0	9.0

### SBBC-2FD 1/2"~4" CLASS 300

SIZE	PORT	L	E	H2	H3	C	ØG	ØJ	ØI	T	F	M	ØN	ØK	ØK1	Z-4	Z1-4			
DN15	1/2"	15.0	140.0	112	8.5	48	9.0	95.3	66.5	35.0	14.3	1.6	4	16.0	50	F05	36	F03	7.0	6.0
DN20	3/4"	20.0	152.0	112	8.5	62	9.0	117.4	82.6	43.0	15.9	1.6	4	19.1	50	F05	36	F03	7.0	6.0
DN25	1"	25.0	165.0	136	11.4	64	9.0	124.0	88.9	51.0	17.5	1.6	4	19.1	50	F05	36	F03	7.0	6.0
DN32	1-1/4"	32.0	178.0	185	11.4	71	9.0	133.4	98.6	63.5	19.1	1.6	4	19.1	50	F05	36	F03	7.0	6.0
DN40	1-1/2"	38.0	190.0	198	14.0	76	14.0	155.5	114.3	73.2	20.6	1.6	4	22.3	70	F07	50	F05	9.0	7.0
DN50	2"	50.0	216.0	198	13.7	84.5	14.0	185.1	127.0	92.0	22.4	1.6	8	19.1	70	F07	50	F05	9.0	7.0
DN65	2-1/2"	64.0	241.0	265	18.0	106.8	17.0	190.5	149.4	104.7	25.4	1.6	8	22.3	102	F10	70	F07	11.0	9.0
DN80	3"	76.0	283.0	265	18.0	116.0	17.0	209.6	168.1	127.0	28.6	1.6	8	22.3	102	F10	70	F07	11.0	9.0
DN100	4"	100.0	305.0	325	18.0	154.5	17.0	254.0	200.2	157.2	31.8	1.6	8	22.3	102	F10	70	F07	11.0	9.0

## FULL-BORE TWO-PIECE SCREWED BALL VALVE & MOUNTING PAD SBSC-2EM3



### SBSC-2EM3 DN15~DN50(1/2"~2")

FULL-BORE TWO-PIECE SCREWED BALL  
VALVE & MOUNTING PAD

- ISO 5211 mounting pad
- Face to face: **DIN 3202 M3**
- Blow-out-proof stem design
- Working pressure: **1000psi**
- Applicable temperature: **-20 to 180°C**
- Pipe thread reference: **ANSI B1. 20. 1 (NPT)**  
**DIN259/DIN2999**  
**ISO228**  
**BSP**  
**PT**

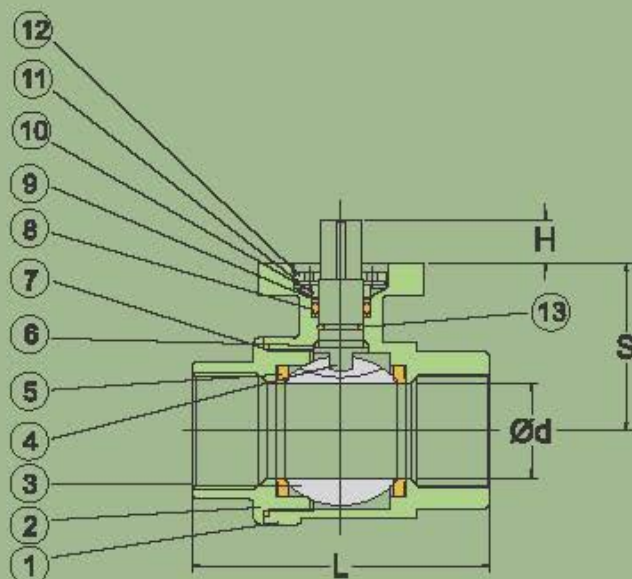
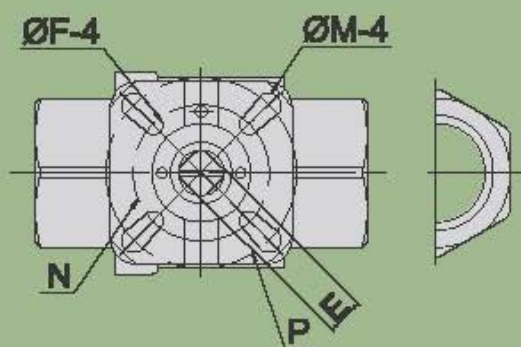



## MATERIALS LIST

NO.	PART NAME	MATERIAL		QTY
		STAINLESS STEEL	CARBON STEEL	
1	BODY	CF8M	WCB	1
2	CAP	CF8M	WCB	1
3	BALL	CF8M	WCB	1
4	STEM	SS316	SS316	1
5	BALL SEATS	PTFE	PTFE	2
6	THRUST WASHER	CARBON ERAPHITE	CARBON ERAPHITE	1
7	GASKET	PTFE	PTFE	1
8	STEM PACKING	PTFE	PTFE	1
9	THRUST WASHER	CARBON ERAPHITE	CARBON ERAPHITE	1
10	FOLLOWER UP	SS304	SS304	1
11	BEVELILLE WASAER	SUS 304-CSP	SUS 304-CSP	1
12	CLANO NUT	SS304	SS304	1
13	O-RING	VITON	VITON	2

## DIMENSIONS

unit:mm

SIZE	d	L	ØF	ØM	ØN	ØP	H	E	S
1/2"	15	75	6	6	36	42	8.12	9	36.95
3/4"	20	80	6	8	36	42	8.50	9	43.50
1"	25	90	6	7	42	50	11.43	11	53.45
1 1/4"	32	110	6	7	42	50	11.43	11	58.95
1 1/2"	38	120	7	9	50	70	17.50	14	67.50
2"	50	140	7	9	50	70	17.45	14	75.05



# FULL-BORE THREE -PIECE BALL VALVE SBSG-3A



## SBSG-3A DN8~DN100(1/4"~4")

FULL-BORE THREE -PIECE BALL VALVE

CONNECTION MODE: SCREWED/BUTT/SOCKET WELD

- Blow-out-proof stem design
- Working pressure: **DN8~DN50 1000psi**  
**DN65~DN80 800psi**
- Applicable temperature: **-20 to 180°C**
- Padlock device
- Pipe thread reference: **ANSI B1. 20. 1 (NPT)**  
**DIN259/DIN2999**  
**ISO228**  
**BSP**  
**PT**

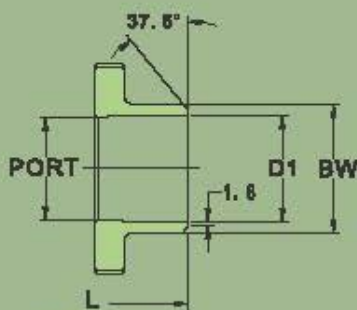

Butt weld end

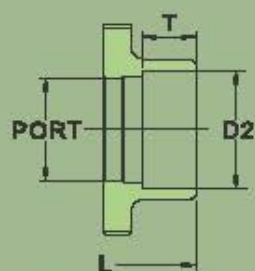

Socket weld end

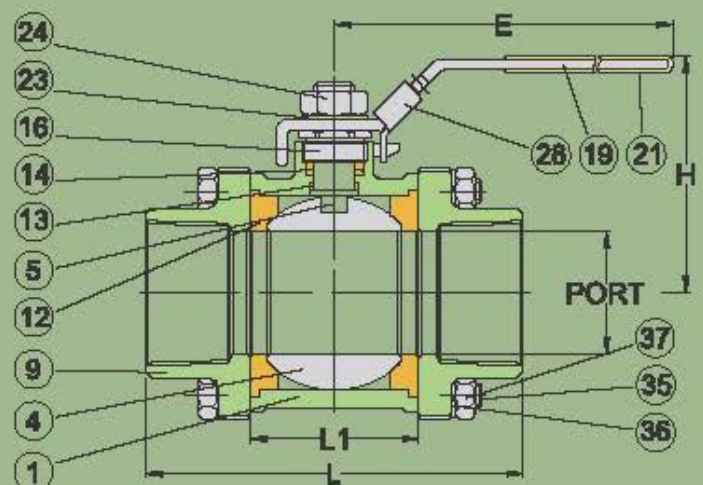



## MATERIALS LIST

NO.	PART NAME	MATERIAL
1	BODY	ASTM A351 Gr.CF8M
4	BALL	ASTM A351 Gr.CF8M
5	STEM	SS316
9	END CAP	ASTM A351 Gr.CF8M
12	SEAT	PTFE.
13	THRUST WASHER	PTFE.
14	STEM PACKING	PTFE.
16	GLAND NUT	SS304
19	HANDLE	SS304
21	HANDLE COVER	PLASTIC
23	HANDLE WASHER	SS304
24	HANDLE NUT	SS304
26	LOCKING DEVICE	SS304 (OPTION)
35	BODY BOLT	SS304
36	BOLT WASHER	SS304
37	BOLT NUT	SS304

## DIMENSIONS

unit:mm

SIZE		PORT	L	E	H	L1	BW	D1	D2	T
DN8	1/4"	11.5	54.0	97.4	49.0	19.0	13.7	11.0	14.2	10.0
DN10	3/8"	12.5	54.0	97.4	49.0	19.0	17.1	12.5	17.5	10.0
DN15	1/2"	15.0	63.5	122.9	58.0	22.5	21.3	15.8	21.8	10.0
DN20	3/4"	20.0	72.5	122.9	61.0	27.5	26.7	20.9	27.4	13.0
DN25	1"	25.0	81.0	144.9	68.0	34.0	33.4	28.6	34.1	13.0
DN32	1-1/4"	32.0	94.5	144.9	73.5	42.5	42.2	35.1	42.7	13.0
DN40	1-1/2"	38.0	108.0	188.9	84.5	52.0	48.3	40.9	49.0	13.0
DN50	2"	50.0	121.5	188.9	93.2	63.5	60.3	52.5	61.0	16.0
DN65	2-1/2"	65.0	157.5	255.3	131.8	85.5	73.0	62.7	77.0	16.0
DN80	3"	80.0	190.0	260.8	140.0	102.0	88.9	77.9	90.2	16.0
DN100	4"	100.0	225.0	322.2	173.6	128.5	114.3	102.3	115.3	22.0



# FULL-BORE THREE -PIECE BALL VALVE SBSG-3CS



## SBSG-3CS DN8~DN100(1/4"~4")

FULL-BORE THREE -PIECE BALL VALVE  
CONNECTION MODE: SCREWED/BUTT/SOCKET WELD

- Blow-out-proof stem design
- Working pressure: **DN8~DN50 1000psi**  
**DN65~DN100 800psi**
- Applicable temperature: **-20 to 180°C**
- Padlock device
- ISO 5211 mounting pad
- Pipe thread reference: **ANSI B1.20.1(NPT)**  
**DIN 259/DIN 2999**  
**ISO 228**  
**BSP**  
**PT**

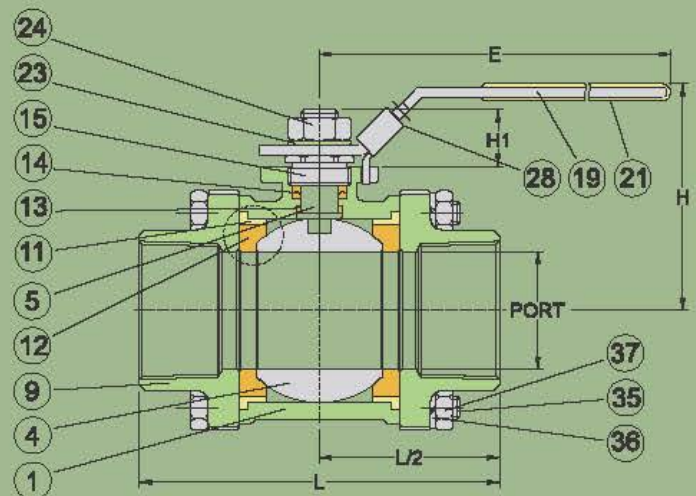
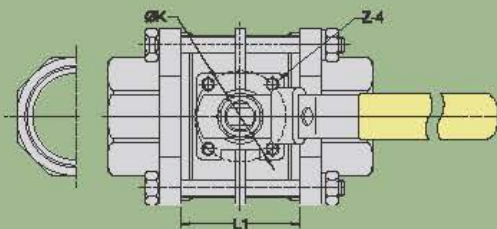
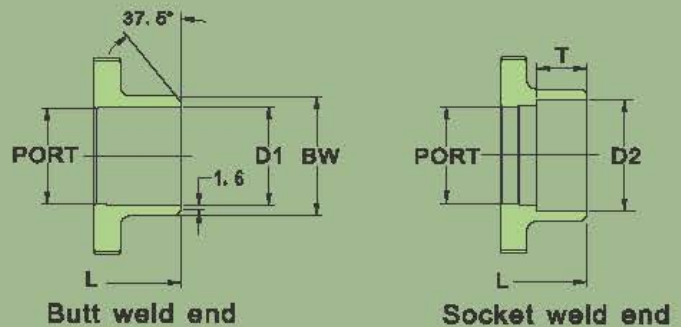



## MATERIALS LIST

NO.	PART NAME	MATERIAL
1	BODY	ASTM A351 Gr.CF8M
4	BALL	ASTM A351 Gr.CF8M
5	STEM	SS316
9	END CAP	ASTM A351 Gr.CF8M
11	BODY SEAL	PTFE.
12	SEAT	RTFE.
13	THRUST WASHER	PTFE.
14	STEM PACKING	PTFE.
15	GLAND	SS304
19	HANDLE	SS304
21	HANDLE COVER	PLASTIC
23	HANDLE WASHER	SS304
24	HANDLE NUT	SS304
28	LOCKING DEVICE	SS304 (OPTION)
35	BODY BOLT	SS304
36	BOLT WASHER	SS304
37	BOLT NUT	SS304

## DIMENSIONS

unit:mm

SIZE	PORT	L	E	H	H1	ØK	Z-4	L1	BW	D1	D2	T	
DN8	1/4"	11.0	63.7	102.0	54.0	13.0	36.0	M5xP0.8	21.0	13.7	11.0	14.2	10.0
DN10	3/8"	12.5	63.7	102.0	54.0	13.0	36.0	M5xP0.8	21.0	17.1	12.5	17.5	10.0
DN15	1/2"	15.0	65.7	102.0	55.0	13.0	36.0	M5xP0.8	22.5	21.3	15.8	21.8	10.0
DN20	3/4"	20.0	76.2	126.0	62.0	17.0	36.0	M5xP0.8	31.0	26.7	20.9	27.4	13.0
DN25	1"	25.4	86.2	126.0	66.0	19.0	36.0	M5xP0.8	40.0	33.4	26.6	34.1	13.0
DN32	1-1/4"	32.0	102.8	154.0	90.0	27.0	50.0	M6xP1.0	50.0	42.2	35.1	42.7	13.0
DN40	1-1/2"	40.0	119.4	154.0	93.0	26.0	50.0	M6xP1.0	58.0	48.3	40.9	49.0	13.0
DN50	2"	50.8	131.4	188.0	102.0	24.0	50.0	M6xP1.0	70.0	60.3	52.5	61.0	16.0
DN65	2-1/2"	65.0	164.0	265.0	121.0	39.0	70.0	M8xP1.25	85.0	73.0	62.7	77.0	16.0
DN80	3"	80.0	182.7	265.0	134.0	37.0	102.0	M10xP1.5	101.5	88.9	77.9	90.2	16.0
DN100	4"	100.0	236.2	272.0	175.0	50.0	102.0	M10xP1.5	122.0	114.3	102.3	115.3	22.0



**JDV  
CONTROL  
VALVES**

# FULL-BORE THREE -PIECE BALL VALVE & MOUNTING PAD SBSG-3D



## SBSG-3D DN8~DN100(1/4"~4")

FULL-BORE THREE -PIECE BALL VALVE & MOUNTING PAD  
CONNECTION MODE: SCREWED/BUTT/SOCKET WELD

- ISO 5211 mounting pad
- Blow-out-proof stem design
- Working pressure: **DN8~DN50 1000psi**  
**DN65~DN80 800psi**
- Applicable temperature: **-20 to 180°C**
- Padlock device
- Pipe thread reference: **ANSI B1. 20. 1 (NPT)**  
**DIN259/DIN2999**  
**ISO228**  
**BSP**  
**PT**

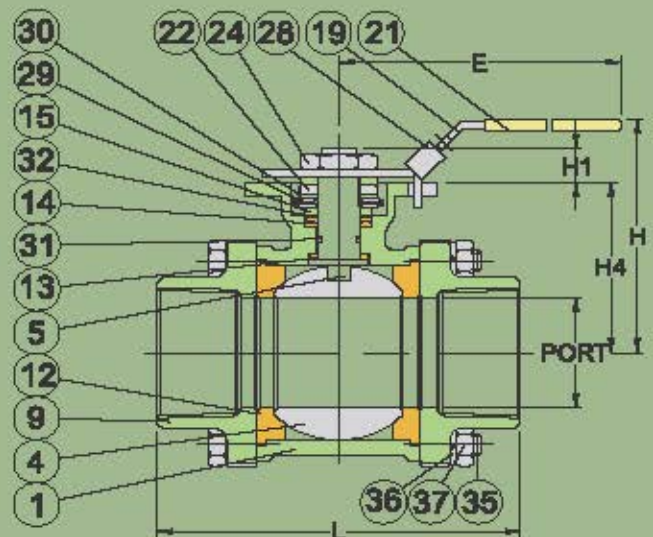
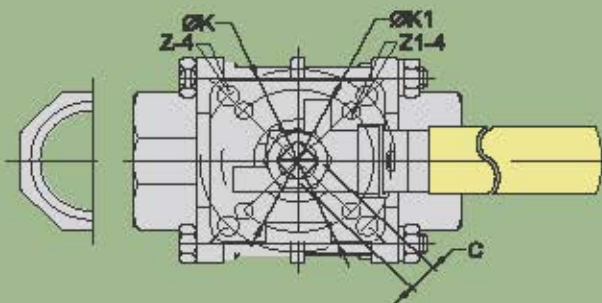
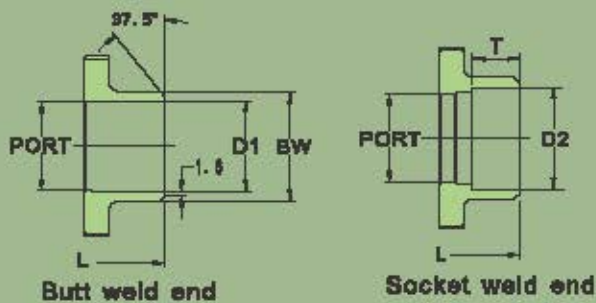

## MATERIALS LIST

NO.	PART NAME	MATERIAL
1	BODY	ASTM A351 Gr.CF8M
4	BALL	ASTM A351 Gr.CF8M
5	STEM	SS316
9	END CAP	ASTM A351 Gr.CF8M
12	SEAT	RTFE.
13	THRUST WASHER	RTFE.
14	STEM PACKING	RTFE.
15	GLAND BUSH	SS304
19	HANDLE	SS304
21	HANDLE COVER	VINYL GRIP
22	STEM NUT	SS304
24	HANDLE NUT	SS304
28	LOCKING PAD	SS304
29	BELLEVILLE WASHER	SS304-CSP
30	TAB WASHER	SS304
31	O-RING	VITON
32	PACKING FOLLWER	PTFE.+25GG.F.
35	BODY BOLT	SS304
38	BOLT WASHER	SS304
37	BOLT NUT	SS304

## DIMENSIONS

unit:mm

SIZE	PORT	L	E	H	H1	H4	C	K	K1	Z-4	Z1-4	D1	BW	D2	T	
DN8	1/4"	11.5	63.5	112.0	73.0	8.5	37.0	9.0	50.0	36.0	7.0	6.0	11.0	13.7	14.2	10.0
DN10	3/8"	12.5	63.5	112.0	73.0	8.5	37.0	9.0	50.0	36.0	7.0	6.0	12.5	17.1	17.6	10.0
DN16	1/2"	15.0	63.5	112.0	73.0	8.5	37.0	9.0	50.0	36.0	7.0	6.0	15.8	21.3	21.8	10.0
DN20	3/4"	20.0	72.5	112.0	80.8	8.5	45.0	9.0	50.0	36.0	7.0	6.0	20.9	26.7	27.4	13.0
DN25	1"	25.0	81.0	136.0	90.5	11.4	53.5	9.0	50.0	36.0	7.0	6.0	28.8	33.4	34.1	13.0
DN32	1-1/4"	32.0	94.5	185.0	98.7	11.4	59.0	9.0	50.0	36.0	7.0	6.0	35.1	42.2	42.7	13.0
DN40	1-1/2"	38.0	108.0	197.9	115.3	14.0	74.8	14.0	70.0	50.0	9.0	7.0	40.9	48.3	49.0	13.0
DN50	2"	50.0	121.5	197.9	124.0	13.7	83.5	14.0	70.0	50.0	9.0	7.0	52.5	60.3	61.0	16.0
DN65	2-1/2"	65.0	157.5	267.0	155.0	18.0	108.8	17.0	102.0	70.0	11.0	9.0	62.7	73.0	77.0	16.0
DN80	3"	80.0	190.0	267.0	208.5	18.0	118.3	17.0	102.0	70.0	11.0	9.0	77.9	86.9	90.2	16.0
DN100	4"	100.0	225.0	322.0	218.7	18.0	153.8	17.0	102.0	70.0	11.0	9.0	102.3	114.3	115.3	22.0



# FULL-BORE THREE -PIECE BALL VALVE & MOUNTING PAD SBSG-3DTC



## SBSG-3DTC DN15~DN100(1/2"~4")

FULL-BORE THREE -PIECE BALL VALVE & MOUNTING PAD

- ISO 5211 mounting pad
- Blow-out-proof stem design
- Clamp
- Working pressure: **DN15~DN50 1000psi**  
**DN65~DN100 800psi**
- Applicable temperature: **-20 to 180°C**
- Padlock device

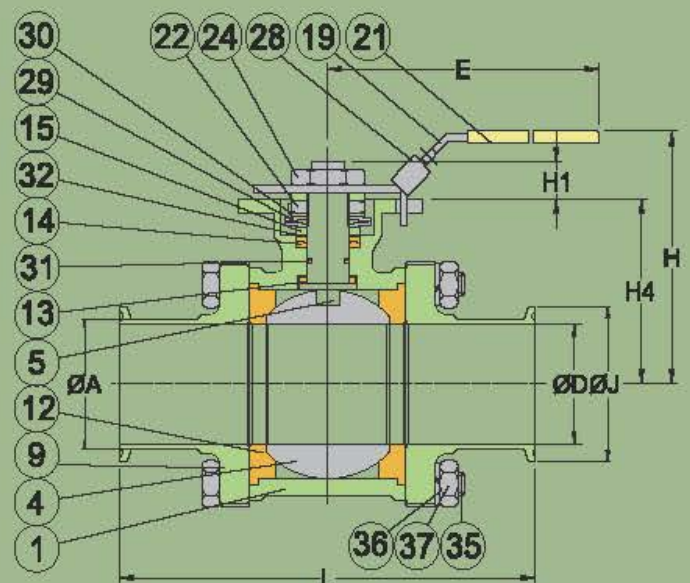
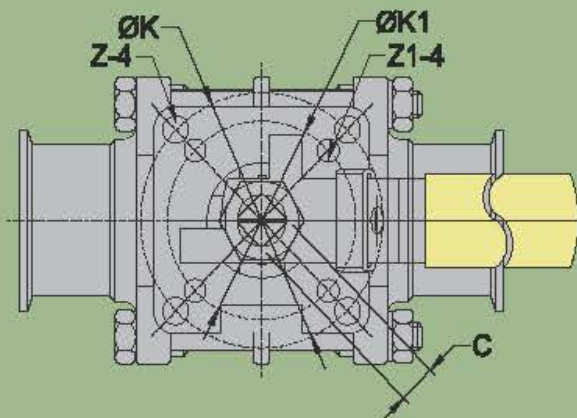



## MATERIALS LIST

NO.	PART NAME	MATERIAL
1	BODY	ASTM A351 Gr.CF8M
4	BALL	SS316
5	STEM	SS316
9	END CAP	ASTM A351 Gr.CF8M
12	SEAT	RTFE.
13	THRUST WASHER	RTFE.
14	STEM PACKING	RTFE.
15	GLAND BUSH	SS304
19	HANDLE	SS304
21	HANDLE COVER	VINYL GRIP
22	STEM NUT	SS304
24	HANDLE NUT	SS304
28	LOCKING PAD	SS304
29	BELLEVILLE WASHER	SS304-CSP
30	TAB WASHER	SS304
31	O-RING	VITON
32	PACKING FOLLWER	PTFE.+25%G.F.
35	BODY BOLT	SS304
36	BOLT WASHER	SS304
37	BOLT NUT	SS304

## DIMENSIONS

unit:mm

SIZE	A	L	E	H	H1	H4	G	K	K1	Z-4	Z1-4	D	J
DN15 1/2"	12.70	70.9	112.0	73.0	8.5	37.0	9.0	50.0	36.0	7.0	6.0	9.40	25.4
DN20 3/4"	19.05	80.8	112.0	80.8	8.5	45.0	9.0	50.0	36.0	7.0	6.0	15.75	25.4
DN25 1"	25.50	90.5	136.0	90.5	11.4	53.5	9.0	50.0	36.0	7.0	6.0	22.20	50.4
DN40 1-1/2"	38.20	115.3	197.9	115.3	14.0	74.8	14.0	70.0	50.0	9.0	7.0	34.90	50.4
DN50 2"	50.80	124.0	197.9	124.0	13.7	83.5	14.0	70.0	50.0	9.0	7.0	47.50	63.9
DN65 2-1/2"	63.60	155.0	267.0	155.0	18.0	108.8	17.0	102.0	70.0	11.0	9.0	60.30	77.5
DN80 3"	76.30	208.5	267.0	208.5	18.0	118.3	17.0	102.0	70.0	11.0	9.0	73.00	90.9
DN100 4"	101.6	216.7	322.0	216.7	18.0	153.8	17.0	102.0	70.0	11.0	9.0	97.40	118.9

# FULL-BORE THREE -PIECE BALL VALVE & MOUNTING PAD SBSA-3D



## SBSA-3D SCH5/SCH10 DN15~DN100(1/2"~4") FULL-BORE THREE -PIECE BALL VALVE & MOUNTING PAD

- ISO 5211 mounting pad
- Blow-out-proof stem design
- Working pressure: **DN15~DN50 1000psi**  
**DN65~DN100 800psi**
- Applicable temperature: **-20 to 180°C**
- Padlock device

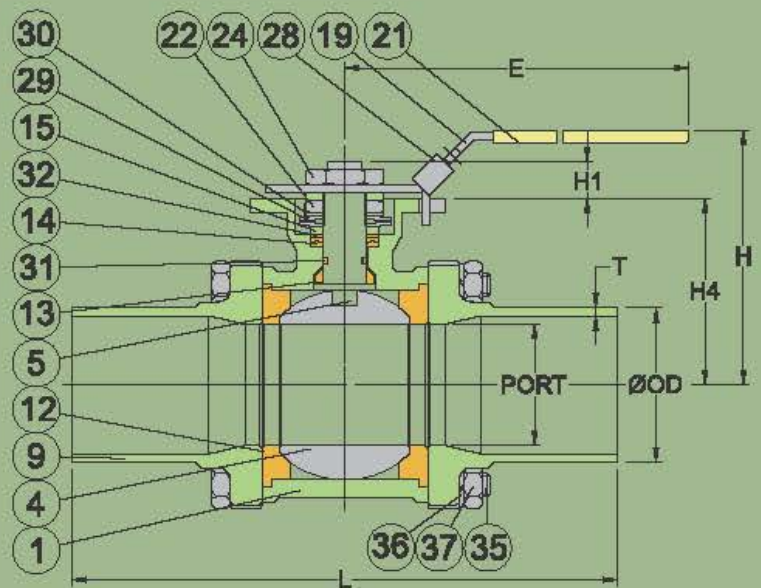
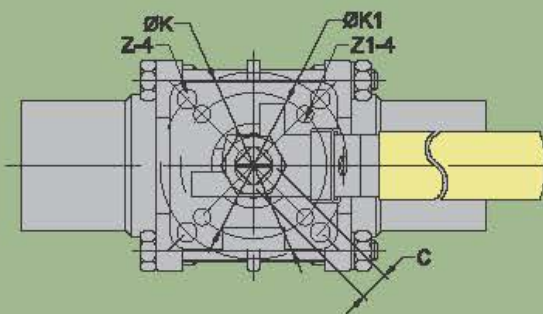

## MATERIALS LIST

NO.	PART NAME	MATERIAL
1	BODY	ASTM A351 Gr.CF8M
4	BALL	ASTM A351 Gr.CF8M
5	STEM	SS316
9	END CAP	ASTM A351 Gr.CF8M/CF3M
12	SEAT	TFM1600.
13	THRUST WASHER	RTFE.
14	STEM PACKING	RTFE.
15	GLAND BUSH	SS304
19	HANDLE	SS304
21	HANDLE COVER	VINYL GRIP
22	STEM NUT	SS304
24	HANDLE NUT	SS304
28	LOCKING PAD	SS304
29	BELLEVILLE WASHER	SS304-CSP
30	TAB WASHER	SS304
31	O-RING	VITON
32	PACKING FOLLWER	PTFE.+25GG.F.
35	BODY BOLT	SS304
36	BOLT WASHER	SS304
37	BOLT NUT	SS304

## DIMENSIONS

unit:mm

SIZE	PORT	L	E	H	H1	H4	C	K	K1	Z-4	Z1-4	OD	T(sch 5)	T(sch 10)	
DN15	1/2"	15.0	135	112.0	73.0	8.5	37.0	9.0	50.0	36.0	7.0	6.0	21.70	1.65	2.11
DN20	3/4"	20.0	135	112.0	80.8	8.5	45.0	9.0	50.0	36.0	7.0	6.0	27.20	1.65	2.11
DN25	1"	25.0	152	136.0	90.5	11.4	53.5	9.0	50.0	36.0	7.0	6.0	34.00	1.65	2.77
DN32	1-1/4"	32.0	157	185.0	98.7	11.4	59.0	9.0	50.0	36.0	7.0	6.0	42.70	1.65	2.77
DN40	1-1/2"	38.0	190	197.9	115.3	14.0	74.8	14.0	70.0	50.0	9.0	7.0	48.60	1.65	2.77
DN50	2"	50.0	204	197.8	124.0	13.7	83.5	14.0	70.0	50.0	9.0	7.0	60.50	1.65	2.77
DN65	2-1/2"	65.0	254	267.0	155.0	18.0	108.8	17.0	102.0	70.0	11.0	9.0	76.30	2.10	3.05
DN80	3"	80.0	280	267.0	208.5	18.0	118.3	17.0	102.0	70.0	11.0	9.0	89.10	2.10	3.05
DN100	4"	100.0	306	322.0	216.7	18.0	153.8	17.0	102.0	70.0	11.0	9.0	114.3	2.10	3.05





**JDV  
CONTROL  
VALVES**

# FULL-BORE THREE -PIECE BALL VALVE & MOUNTING PAD SBSG-3E



## SBSG-3E DN8~DN50 1/4"~2"

FULL-BORE THREE -PIECE BALL VALVE & MOUNTING PAD  
CONNECTION MODE: SCREWED/BUTT/SOCKET WELD

- ISO 5211 mounting pad
- Blow-out-proof stem design
- Working pressure: **DN8~DN50 1000psi**  
**DN65~DN80 800psi**
- Applicable temperature: **-20 to 180°C**
- Padlock device
- Pipe thread reference: **ANSI B1.20.1(NPT)**  
**DIN 259/DIN 2999**  
**ISO 228**  
**BSP**  
**PT**

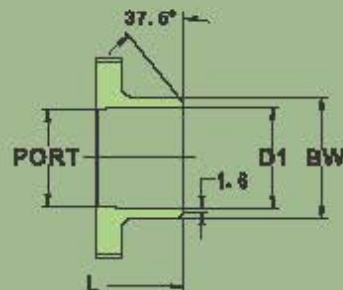

Butt weld end

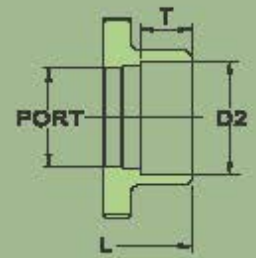

Socket weld end

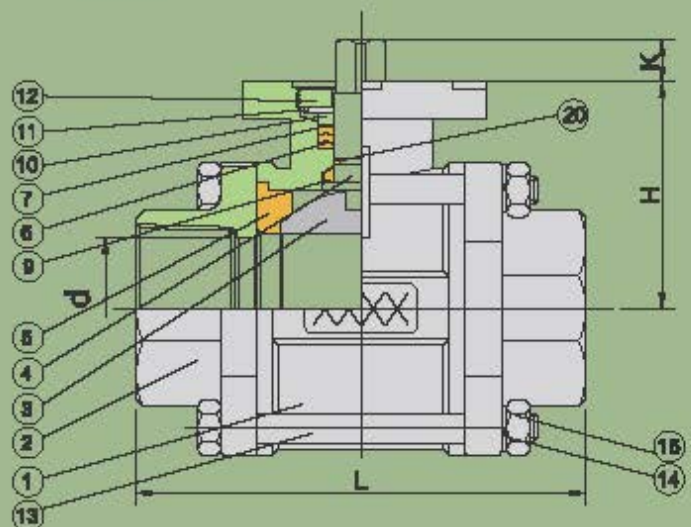
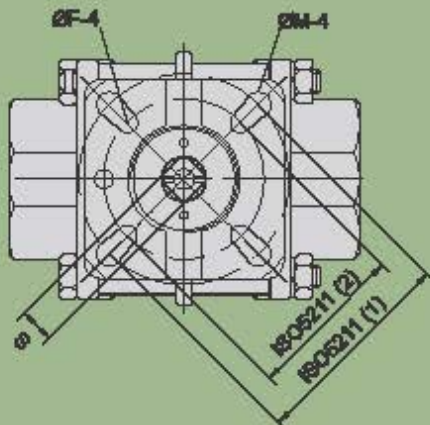



## MATERIALS LIST

NO.	PART NAME	MATERIAL	QTY
1	BODY	ASTMA351 Gr.CF8M	1
2	CAP	S.S.316	2
3	BALL	ASTMA351 Gr.CF3M	1
4	STEM	S.S.316	1
5	BALL SEATS	TEM 1840	2
6	STEM PACKING	PTFE	1
7	THRUST WASHER	PTFE 25GG/F	1
9	THRUST WASHER	PTFE	1
10	FOLLOWER UP	S.S.304	1
11	BEVELILLE WASAER	S.S.401	1
12	CLANO NUT	S.S.304	1
13	BOLTS	S.S.304	4
14	BOLTS NUTS	S.S.304	4
15	BOLTS WASHER	S.S.304	4
16	HANDLE	S.S.304	1
17	HANDLE WASHER	S.S.304	3
18	WASHER	S.S.304	1
19	HANDLE NUT	S.S.304	1
20	O-RING	VITON	1

## DIMENSIONS

unit:mm

SIZE	d	L	ØF	ØM	ISO 5211	S	H	K	BW	D1	D2	T	
1/4"	11.5	63.5	6.0	6.0	36	42	9.0	38.95	8.12	13.7	11.0	14.2	10.0
					F03	F04							
3/8"	12.5	63.5	6.0	6.0	36	42	9.0	38.95	8.12	17.1	12.5	17.5	10.0
					F03	F04							
1/2"	15.0	75	6.0	6.0	36	42	9.0	36.95	8.12	21.3	15.8	21.8	10.0
					F03	F04							
3/4"	20.0	80	6.0	6.0	36	42	9.0	43.50	8.50	26.7	20.9	27.4	13.0
					F03	F04							
1"	25.0	90	6.0	7.0	42	50	11.0	53.45	11.43	33.4	26.6	34.1	13.0
					F04	F05							
1 1/4"	32.0	110	6.0	7.0	42	50	11.0	58.95	11.43	42.2	36.1	42.7	13.0
					F04	F05							
1 1/2"	38.0	120	7.0	9.0	50	70	14.0	68.50	17.5	48.3	40.9	49.0	13.0
					F05	F07							
2"	50.0	140	7.0	9.0	50	70	14.0	75.05	17.5	60.3	52.5	61.0	16.0
					F05	F07							

# FULL-BORE THREE-PIECE SANITARY CLAMP BALL VALVE SBSG-3ATC



## SBSG-3ATC DN15~DN100(1/2"~4") FULL-BORE THREE-PIECE SANITARY CLAMP BALL VALVE

- Blow-out-proof stem design
- Clamp
- Working pressure: **DN15~DN50 1000psi**  
**DN65~DN100 800psi**
- Applicable temperature: **-20 to 180°C**
- Padlock device

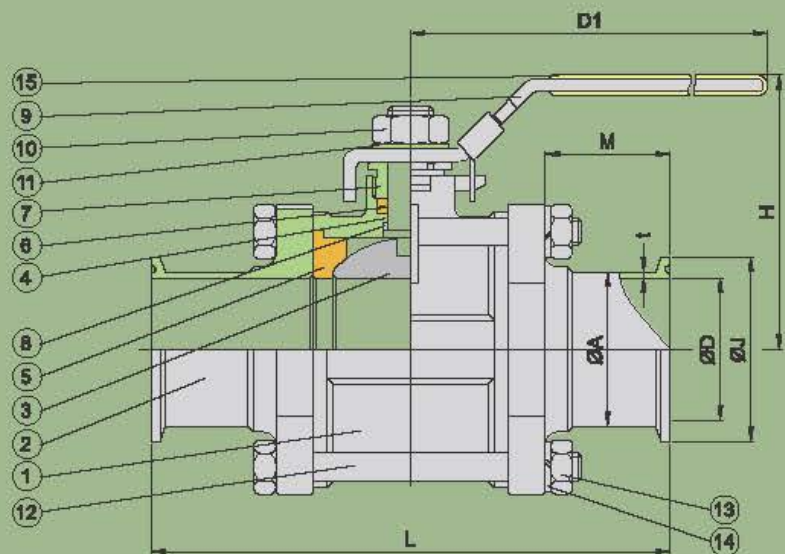
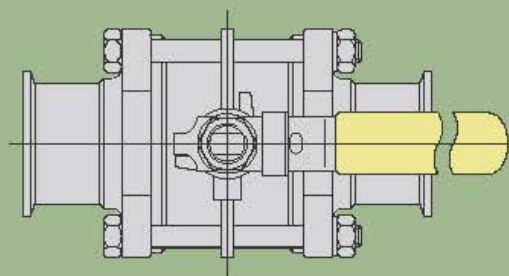

## MATERIALS LIST

NO.	PART NAME	MATERIAL	QTY
		STAINLESS STEEL	
1	BODY	ASTM A351 Gr.CF8M	1
2	CAP	ASTM A351 Gr.CF8M	2
3	BALL	ASTM A276 Gr.316	1
4	STEM	ASTM A276 Gr.316	1
5	BALL SEATS	PTFE	2
6	STEM PACKING	PTFE	1
7	GLAND	S.S.304	1
8	THRUST WASHER	PTFE	1
9	HANDLE	S.S.304	1
10	HANDLE NUT	S.S.304	1
11	HANDLE WASHER	S.S.304	1
12	BOLTS	S.S.304	4-6
13	BOLTS NUTS	S.S.304	4-6
14	BOLTS WASHERS	S.S.304	4-12
15	HANDLE SLEEVE	VINYL GRIP	1

## DIMENSIONS

unit:mm

SIZE	L	A	D	t	J	M	H	D1
1/2"	70.9	12.70	9.40	1.65	25.4	16.7	58.0	122.9
3/4"	97.5	19.05	15.75	1.65	25.4	27.5	61.0	122.9
1"	108.2	25.50	22.20	1.65	50.4	28.6	68.0	144.9
1 1/2"	135.8	38.20	34.90	1.65	50.4	31.4	84.5	188.9
2"	154.7	50.80	47.50	1.65	63.9	34.0	93.2	188.9
2 1/2"	168.5	63.60	60.30	1.65	77.5	28.0	131.8	255.3
3"	196.2	76.30	73.00	1.65	90.9	31.6	140.0	260.8
4"	232.5	101.60	97.40	2.10	118.9	34.0	173.6	322.2





**JDV  
CONTROL  
VALVES**

## FULL-BORE THREE-PIECE LONG TYPE BUTT WELD BALL VALVE SBSG-3A



### SBSG-3A SCH5/SCH10 DN15~DN100(1/2"~4")

FULL-BORE THREE-PIECE LONG TYPE BUTT WELD BALL VALVE

- Blow-out-proof stem design
- Working pressure: **DN15~DN50 1000psi**  
**DN65~DN100 800psi**
- Applicable temperature: **-20 to 180°C**
- Padlock device

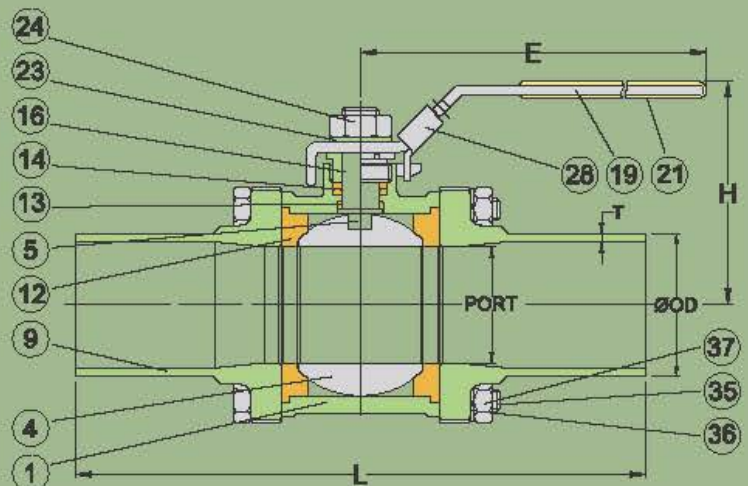
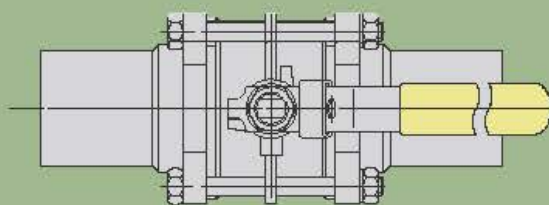

## MATERIALS LIST

NO.	PART NAME	MATERIAL
1	BODY	ASTM A351 Gr.CF8M
4	BALL	ASTM A351 Gr.CF8M
5	STEM	SS316
9	END CAP	ASTM A351 Gr.CF8M
12	SEAT	TFM1600.
13	THRUST WASHER	PTFE.
14	STEM PACKING	PTFE.
16	GLAND NUT	SS304
19	HANDLE	SS304
21	HANDLE COVER	PLASTIC
23	HANDLE WASHER	SS304
24	HANDLE NUT	SS304
28	LOCKING DEVICE	SS304 (OPTION)
35	BODY BOLT	SS304
36	BOLT WASHER	SS304
37	BOLT NUT	SS304

## DIMENSIONS

unit:mm

SIZE		PORT	L	E	H	OD	T(sch5)	T(sch10)
DN15	1/2"	15.0	135	122.9	58.0	21.7	1.65	2.11
DN20	3/4"	20.0	135	122.9	61.0	27.2	1.65	2.11
DN25	1"	25.0	152	144.9	68.0	34.0	1.65	2.77
DN32	1-1/4"	32.0	157	144.9	73.5	42.7	1.65	2.77
DN40	1-1/2"	38.0	190	188.9	84.5	48.6	1.65	2.77
DN50	2"	50.0	204	188.9	93.2	60.5	1.65	2.77
DN65	2-1/2"	65.0	254	255.3	131.8	76.3	2.10	3.05
DN80	3"	80.0	280	260.8	140.0	89.1	2.10	3.05
DN100	4"	100.0	306	322.2	173.6	114.3	2.10	3.05

## FULL-BORE THREE-PIECE LONG TYPE BUTT WELD BALL VALVE SBSG-3A OD



### SBSG-3A OD DN15~DN100(1/2"~4")

FULL-BORE THREE-PIECE LONG TYPE BUTT WELD BALL VALVE

- Blow-out-proof stem design
- Working pressure: **DN15~DN50 1000psi**  
**DN65~DN100 800psi**
- Applicable temperature: **-20 to 180°C**
- Padlock device

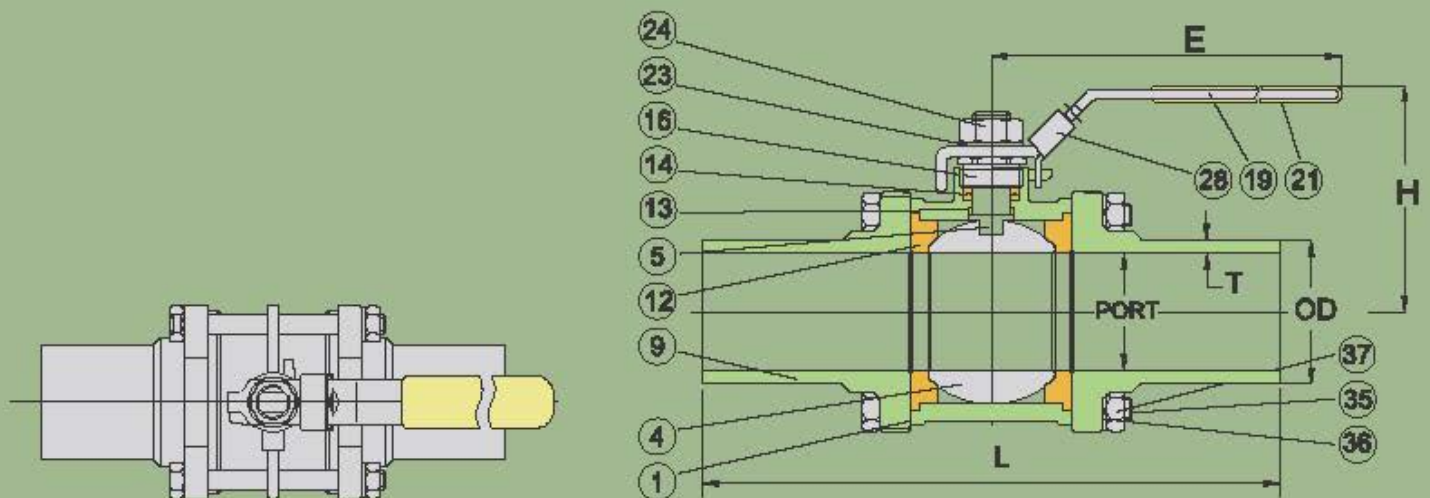



## MATERIALS LIST

NO.	PART NAME	MATERIAL
1	BODY	ASTM A351 Gr.CF8M
4	BALL	ASTM A351 Gr.CF8M
5	STEM	SS316
9	END CAP	ASTM A351 Gr.CF8M
12	SEAT	TFM1600.
13	THRUST WASHER	PTFE.
14	STEM PACKING	PTFE.
16	GLAND NUT	SS304
19	HANDLE	SS304
21	HANDLE COVER	PLASTIC
23	HANDLE WASHER	SS304
24	HANDLE NUT	SS304
28	LOCKING DEVICE	SS304 (OPTION)
35	BODY BOLT	SS304
36	BOLT WASHER	SS304
37	BOLT NUT	SS304

## DIMENSIONS

unit:mm

SIZE		PORT	L	E	H	OD	T
DN15	1/2"	10.2	135	122.9	58.0	12.70	1.24
DN20	3/4"	15.8	135	122.9	61.0	19.05	1.65
DN25	1"	22.1	152	144.9	68.0	25.40	1.65
DN32	1-1/4"	28.5	157	144.9	73.5	31.80	1.65
DN40	1-1/2"	34.8	190	188.9	84.5	38.10	1.65
DN50	2"	47.5	204	188.9	93.2	50.80	1.65
DN65	2-1/2"	60.2	254	255.3	131.8	63.50	1.65
DN80	3"	72.9	280	260.8	140.0	76.20	1.65
DN100	4"	97.4	306	322.2	173.6	101.6	1.65



# FULL-BORE THREE -PIECE FLANGED BALL VALVE SBBE-3AF



## **SBBE-3AF PN16/PN40 DN8-DN100(1/4"-4")** FULL-BORE THREE -PIECE FLANGED BALL VALVE

- Blow-out-proof stem design
- Working pressure: **PN16 bar/PN40 bar**
- Applicable temperature: **-20 to 180°C**
- Padlock device
- Flange connection standard: **DIN 2543**  
**PN16/DIN 2545**  
**PN40(EN 1092-1 RF)**
- Face to face: **EN 558-1/ F1**

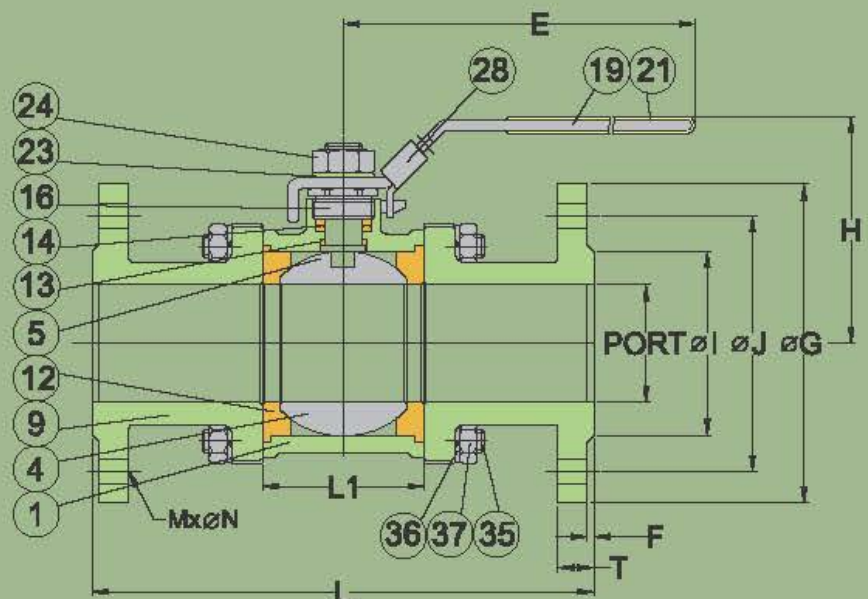

## MATERIALS LIST

NO.	PART NAME	MATERIAL
1	BODY	1.4408 / EN1503-1
4	BALL	CF8M / EN1503-2
5	STEM	SS316
9	END CAP	1.4408 / EN1503-1
12	SEAT	PTFE.
13	THRUST WASHER	PTFE.
14	STEM PACKING	PTFE.
16	GLAND NUT	SS304
19	HANDLE	SS304
21	HANDLE COVER	PLASTIC
23	HANDLE WASHER	SS304
24	HANDLE NUT	SS304
28	LOCKING DEVICE	SS304 (OPTION)
35	BODY BOLT	SS304
36	BOLT WASHER	SS304
37	BOLT NUT	SS304

## DIMENSIONS

unit:mm

### PN40

SIZE	PORT	L	E	H	ØG	ØJ	ØI	T	F	MxØN	C	L1	
DN15	1/2"	15.0	130.0	122.9	88.0	95.0	65.0	45.0	16.0	2.0	4xØ14.0	5.0	22.5
DN20	3/4"	20.0	150.0	122.9	91.0	105.0	75.0	58.0	18.0	2.0	4xØ14.0	5.0	27.5
DN25	1"	25.0	180.0	144.9	104.0	115.0	85.0	68.0	18.0	2.0	4xØ14.0	8.0	34.0
DN32	1-1/4"	32.0	180.0	144.9	108.0	140.0	100.0	78.0	18.0	2.0	4xØ18.0	8.0	42.5
DN40	1-1/2"	38.0	200.0	188.9	121.0	150.0	110.0	88.0	18.0	3.0	4xØ18.0	10.0	52.0
DN50	2"	50.0	230.0	188.9	129.0	165.0	125.0	102.0	20.0	3.0	4xØ18.0	10.0	63.5
DN65	2-1/2"	65.0	290.0	255.3	152.0	185.0	145.0	122.0	22.0	3.0	8xØ18.0	10.0	85.5
DN80	3"	80.0	310.0	260.8	160.0	200.0	160.0	138.0	24.0	3.0	8xØ18.0	12.0	102.0
DN100	4"	100.0	350.0	322.2	174.0	235.0	190.0	162.0	24.0	3.0	8xØ22.0	16.0	128.5

### PN16

SIZE	PORT	L	E	H	ØG	ØJ	ØI	T	F	MxØN	C	L1	
DN15	1/2"	15.0	130.0	122.9	88.0	95.0	65.0	45.0	16.0	2.0	4xØ14.0	5.0	22.5
DN20	3/4"	20.0	150.0	122.9	91.0	105.0	75.0	58.0	18.0	2.0	4xØ14.0	5.0	27.5
DN25	1"	25.0	180.0	144.9	104.0	115.0	85.0	68.0	18.0	2.0	4xØ14.0	8.0	34.0
DN32	1-1/4"	32.0	180.0	144.9	108.0	140.0	100.0	78.0	18.0	2.0	4xØ18.0	8.0	42.5
DN40	1-1/2"	38.0	200.0	188.9	121.0	150.0	110.0	88.0	18.0	3.0	4xØ18.0	10.0	52.0
DN50	2"	50.0	230.0	188.9	129.0	165.0	125.0	102.0	20.0	3.0	4xØ18.0	10.0	63.5
DN65	2-1/2"	65.0	290.0	255.3	152.0	185.0	145.0	122.0	18.0	3.0	4xØ18.0	10.0	85.5
DN80	3"	80.0	310.0	260.8	160.0	200.0	160.0	138.0	20.0	3.0	8xØ18.0	12.0	102.0
DN100	4"	100.0	350.0	322.2	174.0	220.0	180.0	158.0	20.0	3.0	8xØ18.0	16.0	128.5





**JDV  
CONTROL  
VALVES**

# FULL-BORE THREE -PIECE FLANGED BALL VALVE & MOUNTING PAD SBBE-3DF



**SBBE-3DF PN16/PN40 DN8~DN100(1/4"~4")**  
FULL-BORE THREE -PIECE FLANGED BALL VALVE & MOUNTING PAD

- ISO 5211 mounting pad
- Blow-out-proof stem design
- Working pressure: **PN16 bar/PN40 bar**
- Applicable temperature: **-20 to 180°C**
- Padlock device
- Flange connection standard: **DIN 2543**  
**PN16/DIN 2545**  
**PN40(EN 1092-1 RF)**
- Face to face: **EN 558-1/ F1**

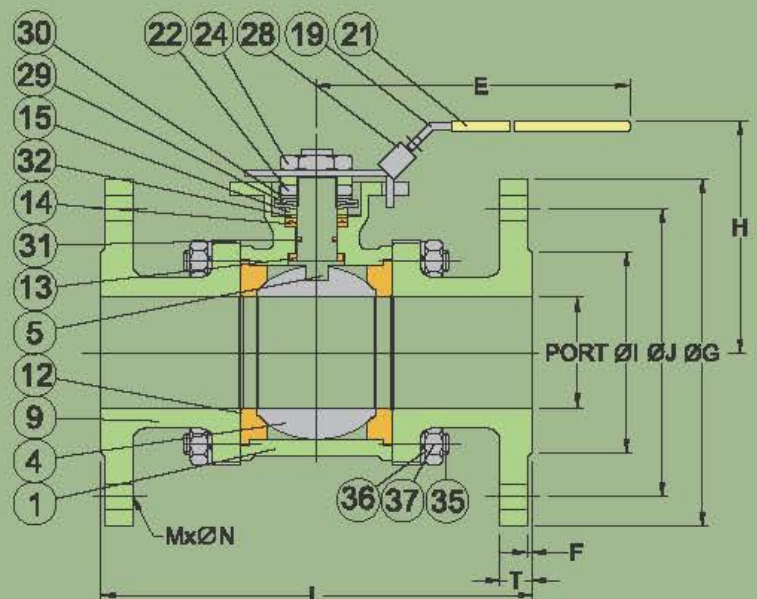
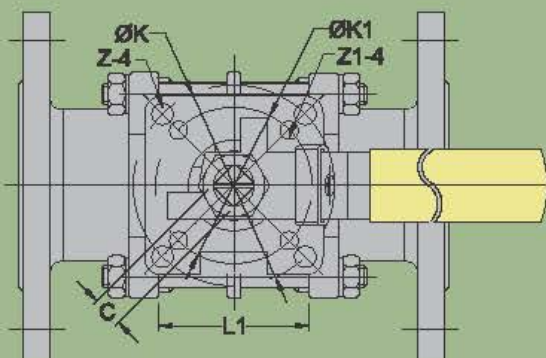

## MATERIALS LIST

NO.	PART NAME	MATERIAL
1	BODY	1.4408 / EN1503-1
4	BALL	CF8M / EN1503-2
5	STEM	SS316
9	END CAP	1.4408 / EN1503-1
12	SEAT	RTFE.
13	THRUST WASHER	RTFE.
14	STEM PACKING	RTFE.
15	GLAND BUSH	SS304
19	HANDLE	SS304
21	HANDLE COVER	VINYL GRIP
22	STEM NUT	SS304
24	HANDLE NUT	SS304
28	LOCKING PAD	SS304
29	BELLEVILLE WASHER	SS304-CSP
30	TAB WASHER	SS304
31	O-RING	VITON
32	PACKING FOLLWER	PTFE.+25GGF
35	BODY BOLT	SS304
38	BOLT WASHER	SS304
37	BOLT NUT	SS304

## DIMENSIONS

unit:mm

### PN40

SIZE	PORT	L	E	H	C	ØG	ØJ	ØI	T	F	MxØN	ØK	ØK1	Z-4	Z1-4	L1	
DN15	1/2"	15.0	130.0	112.0	74.0	9.0	95.0	65.0	45.0	18.0	2.0	4xØ14	50.0	36.0	7.0	6.0	22.5
DN20	3/4"	20.0	150.0	112.0	81.0	9.0	105.0	75.0	58.0	18.0	2.0	4xØ14	50.0	36.0	7.0	8.0	27.5
DN25	1"	25.0	160.0	138.0	90.5	9.0	115.0	85.0	68.0	18.0	2.0	4xØ14	50.0	36.0	7.0	8.0	34.0
DN32	1-1/4"	32.0	180.0	185.0	98.7	9.0	140.0	100.0	78.0	18.0	2.0	4xØ18	50.0	36.0	7.0	6.0	42.5
DN40	1-1/2"	38.0	200.0	198.0	115.3	14.0	150.0	110.0	88.0	18.0	3.0	4xØ18	70.0	50.0	9.0	7.0	52.0
DN50	2"	50.0	230.0	198.0	124.0	14.0	165.0	125.0	102.0	20.0	3.0	4xØ18	70.0	50.0	9.0	7.0	63.5
DN65	2-1/2"	65.0	290.0	267.0	155.0	17.0	185.0	145.0	122.0	22.0	3.0	8xØ18	102.0	70.0	11.0	9.0	85.5
DN80	3"	80.0	310.0	267.0	208.5	17.0	200.0	160.0	138.0	24.0	3.0	8xØ18	102.0	70.0	11.0	9.0	102.0
DN100	4"	100.0	350.0	322.0	218.7	17.0	235.0	190.0	162.0	24.0	3.0	8xØ22	102.0	70.0	11.0	9.0	128.5

### PN16

SIZE	PORT	L	E	H	C	ØG	ØJ	ØI	T	F	MxØN	ØK	ØK1	Z-4	Z1-4	L1	
DN15	1/2"	15.0	130.0	112.0	74.0	9.0	95.0	65.0	45.0	18.0	2.0	4xØ14	50.0	36.0	7.0	6.0	22.5
DN20	3/4"	20.0	150.0	112.0	81.0	9.0	105.0	75.0	58.0	18.0	2.0	4xØ14	50.0	36.0	7.0	6.0	27.5
DN25	1"	25.0	160.0	136.0	90.6	9.0	115.0	85.0	68.0	18.0	2.0	4xØ14	50.0	36.0	7.0	6.0	34.0
DN32	1-1/4"	32.0	180.0	185.0	98.7	9.0	140.0	100.0	78.0	18.0	2.0	4xØ18	50.0	36.0	7.0	6.0	42.5
DN40	1-1/2"	38.0	200.0	198.0	115.3	14.0	150.0	110.0	88.0	18.0	3.0	4xØ18	70.0	50.0	9.0	7.0	52.0
DN50	2"	50.0	230.0	198.0	124.0	14.0	165.0	125.0	102.0	20.0	3.0	4xØ18	70.0	50.0	9.0	7.0	63.5
DN65	2-1/2"	65.0	290.0	267.0	155.0	17.0	185.0	145.0	122.0	18.0	3.0	4xØ18	102.0	70.0	11.0	9.0	85.5
DN80	3"	80.0	310.0	267.0	208.5	17.0	200.0	160.0	138.0	20.0	3.0	8xØ18	102.0	70.0	11.0	9.0	102.0
DN100	4"	100.0	350.0	322.0	216.7	17.0	220.0	180.0	158.0	20.0	3.0	8xØ18	102.0	70.0	11.0	9.0	128.5

# FULL-BORE THREE -PIECE CHECK VALVE SBSG-3AZ3



## SBSG-3AZ3 DN8~DN100 (1/4"~4")

FULL-BORE THREE -PIECE CHECK VALVE

- Applicable temperature: **-20 to 180°C**
- Connection mode: Screwed
- Pipe thread reference: **ANSI B1. 20. 1 (NPT)**  
**DIN259/DIN2999**  
**ISO228**  
**BSP**  
**PT**

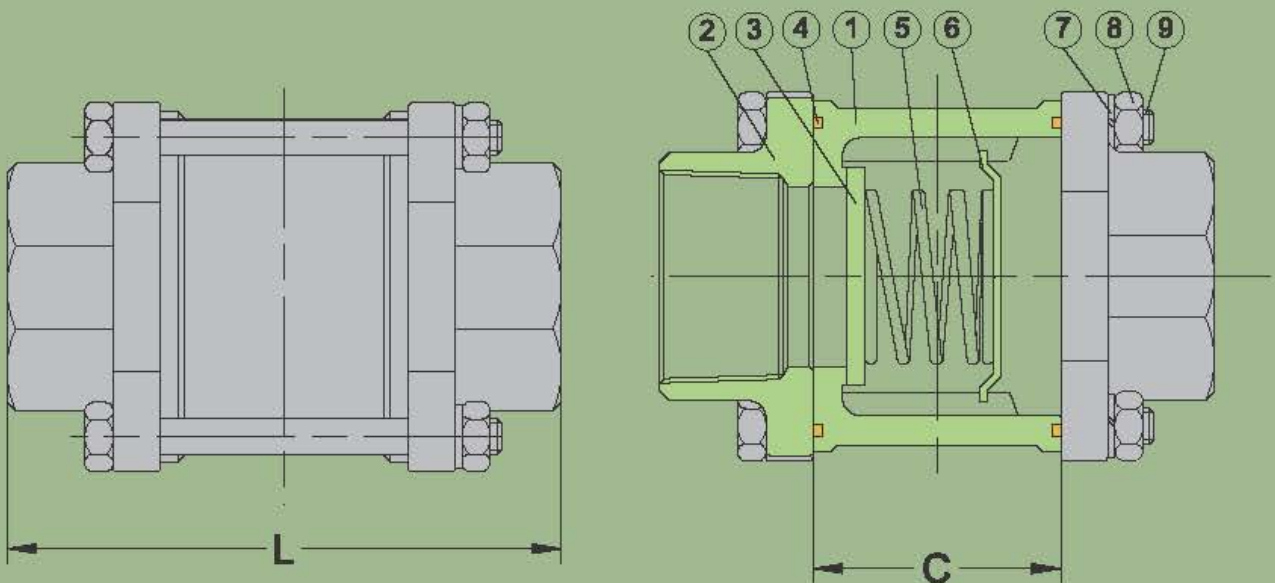



### MATERIALS LIST

NO.	PART NAME	STAINLESS STEEL
1	BODY	ASTM A351 CF8M
2	END CAP	ASTM A351 CF8M
3	DISC	T-316 STAINLESS STEEL
4	BODY SEAL	PTFE
5	SPRING	300 SERIES ST. ST.
6	SPRING HOLDER	T-316 STAINLESS STEEL
7	WASHER	SS 304
8	NUT	SS 304
9	BOLT	SS 304

### DIMENSIONS

unit:mm

MM	IN	ØB	L	C
8.0	1/4"	10.0	49	14.0
10.0	3/8"	10.0	49	14.0
15.0	1/2"	14.0	65	18.0
20.0	3/4"	18.1	70	22.0
25.0	1"	24.2	78	27.5
32.0	1 1/4"	30.2	96	32.0
40.0	1 1/2"	36.2	102	37.0
50.0	2"	48.3	118	47.0
65.0	2 1/2"	63.0	145	47.0
80.0	3"	76.0	156	55.0
100.0	4"	98.0	181.5	70.0

# REDUCE PORT THREE-WAY SCREWED BALL VALVE SBCC-B



## SBCC-B DN8~DN80 1/4"~3" REDUCE PORT THREE-WAY SCREWED BALL VALVE

- Blow-out-proof stem design
- ISO 5211 mounting pad
- Working pressure: **1000psi PN63 bar**
- Applicable temperature: **-20 to 180°C**
- Padlock device
- 4-seat design
- L port or T port handle can rotate 360 degrees

Flow Patterns for L-Port

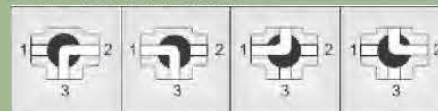

Flow Patterns for T-Port

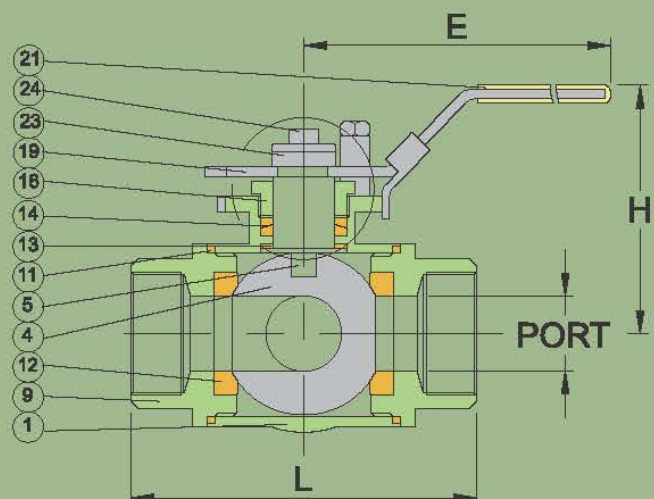
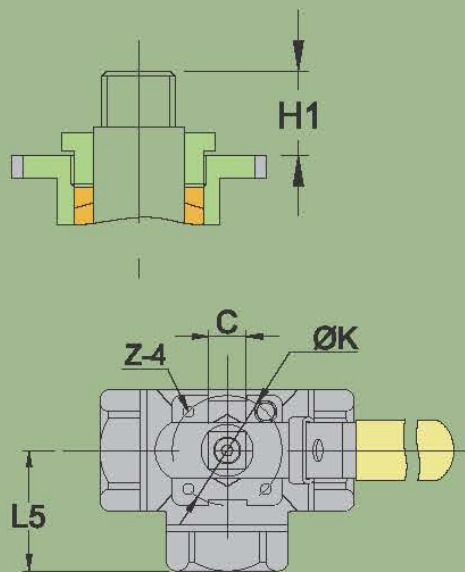
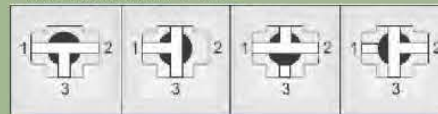

## MATERIALS LIST

NO.	PART NAME	MATERIAL
1	BODY	ASTMA351 Gr.CF8M
4	BALL	ASTMA351 Gr.CF8M
5	STEM	SS316
9	END CAP	ASTMA351 Gr.CF8M
11	BODY SEAL	PTFE.
12	SEAT	RTFE.
13	THRUST WASHER	PTFE.
14	STEM PACKING	PTFE.
16	GLAND NUT	SS304
19	HANDLE	SS304
21	HANDLE COVER	VINYL GRIP
23	HANDLE WASHER	SS304
24	HANDLE NUT	SS304

## DIMENSIONS

unit:mm

SIZE	PORT	L	L5	E	H	H1	C	ØK	Z-4	
DN8	1/4"	11.0	69.4	34.6	133.4	60.7	10.7	9.0	42.0	M5xP0.8
DN10	3/8"	11.0	69.4	34.6	133.4	60.7	10.7	9.0	42.0	M5xP0.8
DN15	1/2"	12.5	75.7	37.3	133.4	64.1	10.7	9.0	42.0	M5xP0.8
DN20	3/4"	16.0	86.6	44.7	178.5	82.4	13.9	11.0	50.0	M6xP1.0
DN25	1"	20.0	102.4	51.4	178.5	86.1	20.0	11.0	50.0	M6xP1.0
DN32	1-1/4"	25.0	118.2	57.7	209.9	91.4	23.8	11.0	50.0	M6xP1.0
DN40	1-1/2"	32.0	125.8	62.7	208.0	102.7	25.8	11.0	70.0	M8xP1.25
DN50	2"	38.0	149.0	74.6	229.9	110.7	25.3	14.0	70.0	M8xP1.25
DN65	2-1/2"	50.0	160.0	80.0	229.9	115.8	24.5	14.0	70.0	M8xP1.25
DN80	3"	65.0	185.0	92.5	265.0	132.0	25.5	17.0	102.0	M10xP1.5



# REDUCE PORT THREE-WAY SCREWED BALL VALVE SBCC-D



## SBCC-D DN8~DN50 1/4"~2" REDUCE PORT THREE-WAY SCREWED BALL VALVE

- Blow-out-proof stem design
- ISO 5211 mounting pad
- Working pressure: **1000psi PN63 bar**
- Applicable temperature: **-20 to 180°C**
- Padlock device
- 4-seat design
- L port or T port handle can rotate 360 degrees

Flow Patterns for L-Port

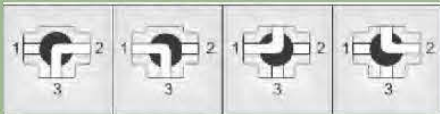

Flow Patterns for T-Port

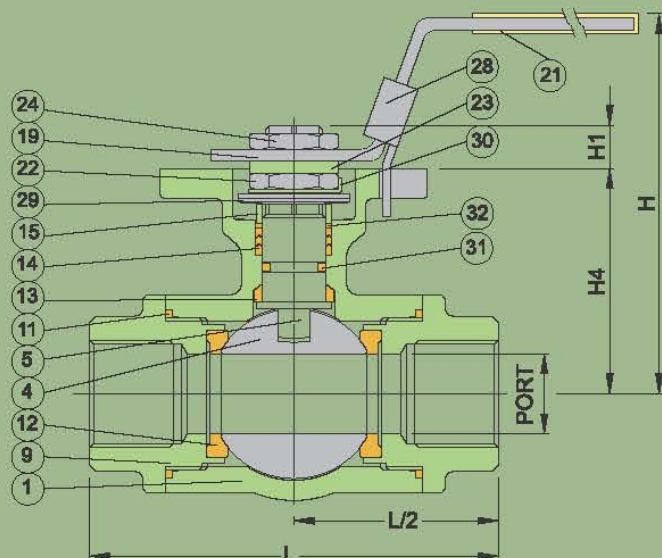
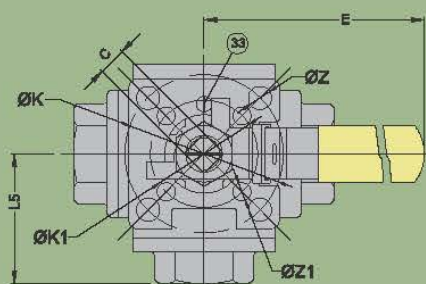
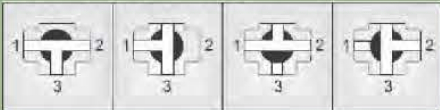

## MATERIALS LIST

NO.	PART NAME	MATERIAL
1	BODY	ASTM A351 Gr.CF8M
4	BALL	ASTM A351 Gr.CF8M
5	STEM	SS316
9	CAP	ASTM A351 Gr.CF8M
11	BODY SEAL	PTFE.
12	SEAT	RTFE.
13	THRUST WASHER	RTFE.
14	STEM PACKING	RTFE.
15	GLAND BUSH	SS304
19	HANDLE	SS304
21	HANDLE COVER	PLASTIC
22	STEM NUT	SS304
23	HANDLE WASHER	SS304
24	HANDLE NUT	SS304
28	LOCKING PAD	SS304
29	BELLEVEILLE WASHER	SS304-CSP
30	STOP WASHER	SS304
31	O-RING	VITON
32	PACKING FOLLOWER	PTFE.+25GGF
33	STOP PIN	SS304

## DIMENSIONS

unit:mm

SIZE	PORT	L	L5	E	H	H1	H4	C	Y	øK	øK1	Z	Z1			
DN8	1/4"	11.0	75.7	37.3	112.0	77.5	9.0	38.2	9.0	12.0	42.0	F-04	6.0			
DN10	3/8"	11.0	75.7	37.3	112.0	77.5	9.0	38.2	9.0	12.0	42.0	F-04	6.0			
DN15	1/2"	12.7	75.7	37.3	112.0	77.5	9.0	38.2	9.0	12.0	42.0	F-04	6.0			
DN20	3/4"	16.0	86.6	44.7	112.0	82.0	9.0	45.2	9.0	12.0	42.0	F-04	6.0			
DN25	1"	20.0	102.4	51.4	136.5	93.7	11.0	56.5	11.0	15.8	50.0	F-05	7.1			
DN32	1-1/4"	25.0	118.2	57.7	188.0	101.1	11.0	61.9	11.0	15.8	50.0	F-05	7.1			
DN40	1-1/2"	32.0	125.8	62.7	197.5	120.3	14.3	78.3	14.0	20.8	70.0	F-07	50.0	F-05	9.2	7.1
DN50	2"	38.1	149.0	74.6	197.5	129.9	14.0	87.4	14.0	20.8	70.0	F-07	50.0	F-05	9.2	7.1



**JDV  
CONTROL  
VALVES**

# REDUCE PORT THREE-WAY SCREWED BALL VALVE SBCC-E



## SBCC-E DN8~DN50 (1/4"~2") REDUCE PORT THREE-WAY SCREWED BALL VALVE

- Blow-out-proof stem design
- ISO 5211 mounting pad
- Working pressure: **1000psi PN63 bar**
- Applicable temperature: **-20 to 180°C**
- Padlock device
- L port or T port handle can rotate 360 degrees

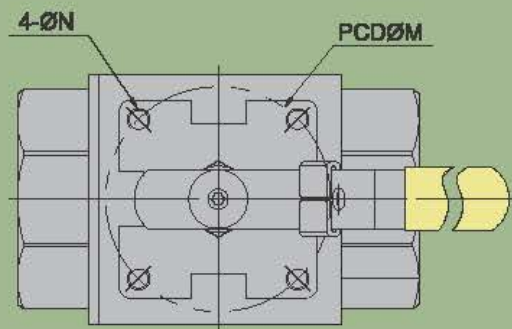

PORT TYPE	1	2	3	4
T3	1 ⊕ 2	1 ⊕ 2		
T4	1 ⊕ 2	1 ⊕ 2	1 ⊕ 2	1 ⊕ 2

PORT TYPE	1	2	3	4
L3	1 ⊕ 2	1 ⊕ 2	1 ⊕ 2	1 ⊕ 2
L2	1 ⊕ 2	1 ⊕ 2	1 ⊕ 2	1 ⊕ 2

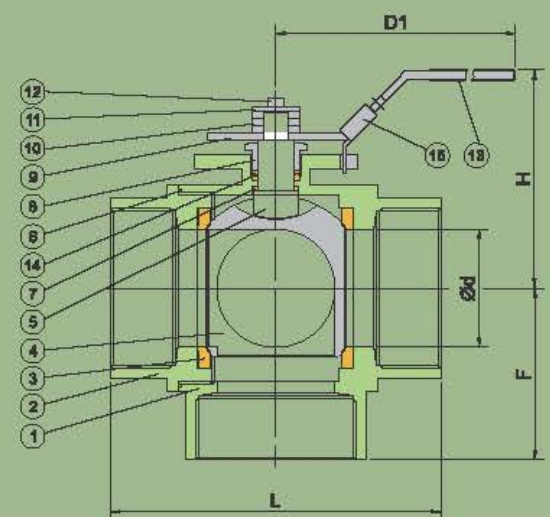
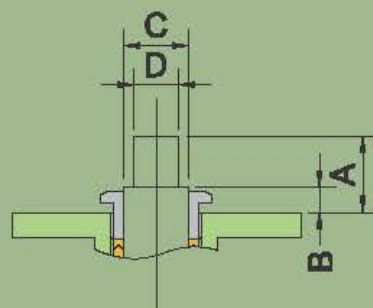



## MATERIALS LIST

NO.	PART NAME	MATERIAL
1	BODY	ASTM A351 GR.CF8M
2	CAP	ASTM A351 GR.CF8M
3	SEAT	PTFE
4	BALL	ASTM A351 GR.CF8M
5	STEM	S.S 316
6	END SEALS	PTFE
7	THRUST WASHR	PTFE
8	GLAND	S.S 304
9	HANDLE	S.S 304
10	HANDLE WASHER	S.S 304
11	WASHER	S.S 304
12	HANDLE NUT	S.S 304
13	HANDLE SLEEVE	VINYL GRIP
14	STEM PACKINGS	PTFE
15	LOCKING PLATE	S.S 304

## DIMENSIONS

unit:mm

SIZE	d	A	B	C	D	D1	H	F	L	M	N
1/4"	11.0	10.9	5.9	12.0	9.0	133.4	62.7	29.0	57.2	36.0	M5*0.8
3/8"	11.0	10.9	5.9	12.0	9.0	133.4	62.7	29.0	57.2	36.0	M5*0.8
1/2"	12.5	10.9	5.9	12.0	9.0	133.4	64.7	34.5	66.0	36.0	M5*0.8
3/4"	16.0	11.4	6.4	12.0	9.0	133.4	78.7	39.7	85.8	36.0	M5*0.8
1"	20.0	11.4	6.4	12.0	9.0	133.4	71.2	46.0	88.5	42.0	M5*0.8
1-1/4"	25.4	23.7	8.2	15.0	11.0	178.5	90.2	51.7	103.4	50.0	M6*1.0
1-1/2"	31.8	23.7	8.2	15.0	11.0	178.5	93.7	61.0	111.1	50.0	M6*1.0
2"	38.1	23.7	8.2	15.0	11.0	178.5	98.2	71.4	136.4	50.0	M6*1.0









# REDUCE PORT THREE-WAY SCREWED BALL VALVE SBCC-C



## SBCC-C DN8~DN50 (1/4"~2")

REDUCE PORT THREE-WAY SCREWED BALL VALVE

- Blow-out-proof stem design
- ISO 5211 mounting pad
- Working pressure: **1000psi PN63 bar**
- Applicable temperature: **-20 to 180°C**
- Padlock device
- L port or T port handle can rotate 360 degrees

PORT \ TURN	TURN			
	0°	90°	180°	270°
L				
T				

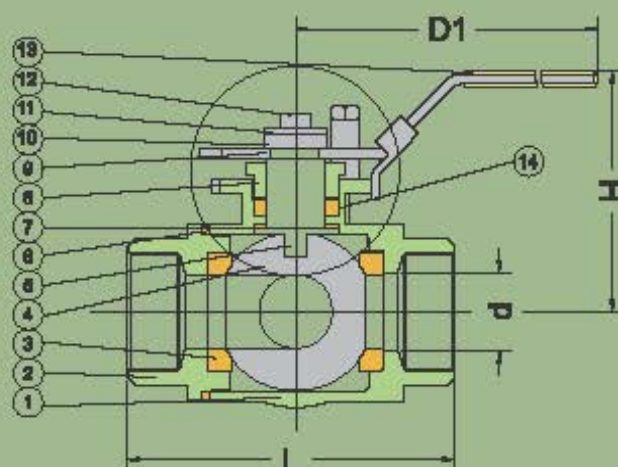
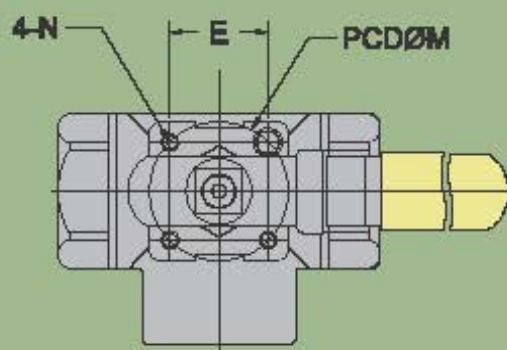
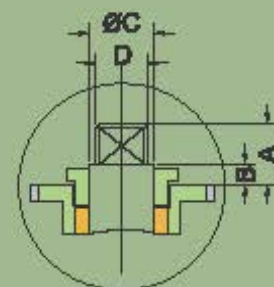

## MATERIALS LIST

NQ	PART	MATERIAL
1	BODY	A351 GR.CF8M
2	CAP	A351 GR.CF8M
3	SEAT	PTFE
4	BALL	A351 GR.CF8M
5	STEM	S.S 316
6	END SEALS	PTFE
7	THRUST WASHER	PTFE
8	GLAND	S.S.304
9	HANDLE	S.S.304
10	HANDLE WASHER	S.S.304
11	WASHER	S.S.304
12	HANDLE NUT	S.S.304
13	HANDLE SLEEVE	VINYL GRIP
14	STEM PACKINGS	PTFE

## DIMENSIONS

unit:mm

SIZE	d	L	H	D1	A	B	C	D	E	F	M	N
1/4"	11.0	67.2	62.7	133.0	11.0	6	12	9	25.0	29.0	36	M5*0.8
3/8"	11.0	57.2	62.7	133.0	11.0	6	12	9	25.0	29.0	36	M5*0.8
1/2"	12.5	66.0	64.7	133.0	11.0	6	12	9	25.0	33.5	36	M5*0.8
3/4"	16.0	77.0	67.7	133.0	11.0	6	12	9	25.0	38.7	36	M5*0.8
1"	20.0	88.0	71.2	133.0	11.0	6	12	9	29.0	48.0	42	M5*0.8
1-1/4"	25.4	103	88.7	178.5	23.5	8	15	11	35.5	51.7	50	M8*1.0
1-1/2"	31.8	111	93.7	178.5	23.5	8	15	11	35.5	61.0	50	M8*1.0
2"	38.1	136	98.2	178.5	23.5	8	15	14	35.5	71.4	50	M8*1.0



# Y-TYPE STRAINER SPV-Y



## SPV-Y DN8~DN80 1/4"~3" Y-TYPE STRAINER

- Applicable temperature: -20 to 180°C
- Connection mode: Screwed
- Pipe thread reference: ANSI B1.20.1(NPT)  
DIN 259/DIN 2999  
ISO 228  
BSP  
PT

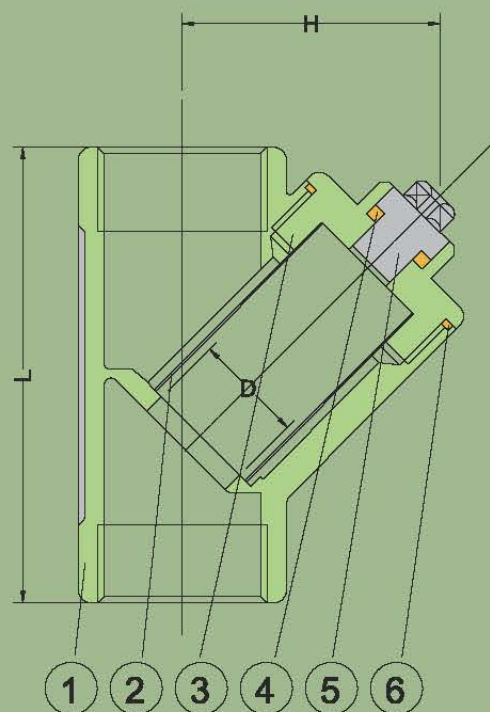
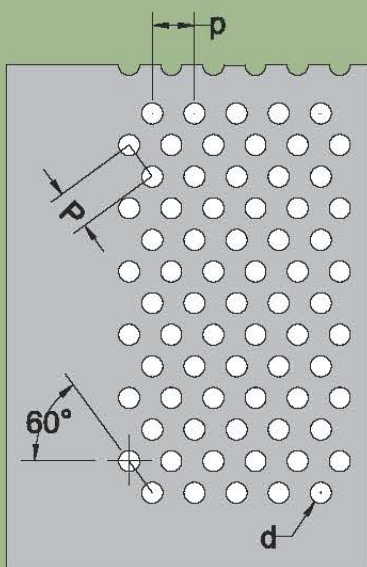
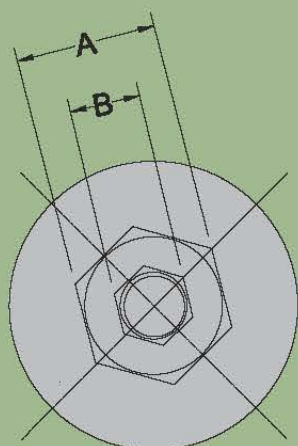

## MATERIALS LIST

NO.	PART	Q,TY	MATERIAL
1	BODY	1	316/304
2	SCREEN	1	316/304
3	BONNET	1	316/304
4	PACKING	1	CARBON:PTFE
5	PLUG	1	316/304
6	GASKET	1	PTFE

## DIMENSIONS

unit:mm

SIZE	L	H	D	p	d	A	B
1/4"	57.0	35.0	10.0	2.0	1.0	16.0	8.0
3/8"	57.0	35.0	10.0	2.0	1.0	16.0	8.0
1/2"	61.0	38.0	15.0	2.0	1.0	16.0	8.0
3/4"	70.0	42.0	20.0	2.0	1.0	16.0	8.0
1"	86.0	50.0	25.0	2.0	1.0	20.7	10.0
1-1/4"	99.0	55.0	32.0	2.0	1.0	25.0	12.0
1-1/2"	111.0	59.0	38.0	2.0	1.0	25.0	12.0
2"	137.0	73.0	51.0	2.0	1.0	32.0	12.0
2-1/2"	172.0	91.0	65.0	2.0	1.0	38.0	15.0
3"	205.0	110.0	80.0	2.0	1.0	38.0	15.0



■ HEADQUARTERS

NO. 6-1, QINGNIAN RD., YANGMEI CITY, TAOYUAN COUNTY 326, TAIWAN  
TEL +886-3-4965066 FAX +886-3-4963526 E-MAIL: sales@jdv.com.tw



Copyright 2014/11. All rights are reserved by JDV.  
The technical date and content may be changed without prior notice.